

Compact-Body Sensor Sprue Gripper – DD20-16

(Dimensioned drawing shown full scale)

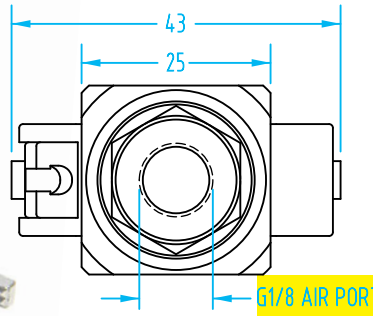

Thin Jaws with Long Reach!

- New Sensor Slot position provides sensing without interfering with the part being gripped.
- Angular, self-centering.
- Gripper has a G1/8" air port.
- Sensors sold separately, see page 448.
- Higher grip force than GRZ20-16 grippers.
- Clampable along full length of Ø20mm body.
- Diamond-textured fingers provide excellent gripping of small to large sprues. This design is also excellent for sprues that need to be pulled or stripped from a mold cavity.
- 20mm diameter mounting body allows this gripper to be used with standard mounting components.
- Replacement parts available online.
- Replaces older model: DD20-16B-J (#7444)

SET-UP NOTE: The sensor will only send a signal when the gripper is actuated with compressed air.

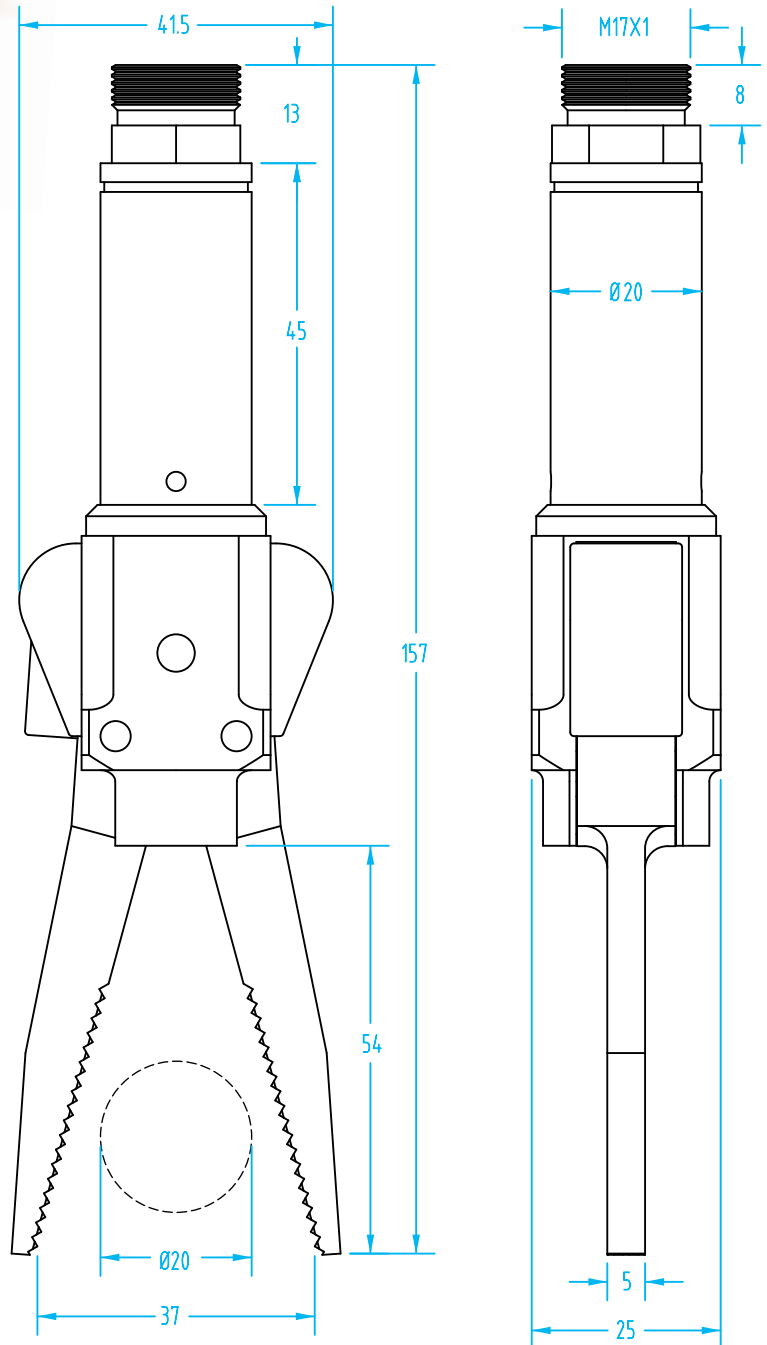

NEW

Part#	DD20-16B2
Quick#	7553
Price	\$259.00
Style	Long Saw Jaws
Applicable Sprue	3–20mm
lbs. Force at 30mm Tooling Length*	45.0 lbf
Weight	140g

* The Closing Force listed is both jaws combined when supplied at 87psi. Tooling length is measured from jaw pivot point.

Order sensors separately See Sensor Reference Guide on page 1008 for a complete list of sensors for DD Grippers.