

**2-jaw parallel self-centering pneumatic gripper (series PE)**

- Double acting (single acting upon request for PE-25... and PE-45...).
- High efficiency and reliability due to the lack of driving parts.
- Wide choice of stroke length options.
- The gripping force is constant on both directions along total stroke.
- Light weight; due to its alloy construction.
- FDA-H1 food-grade grease.



PE-4580



PE-4560



PE-4540



PE-4520

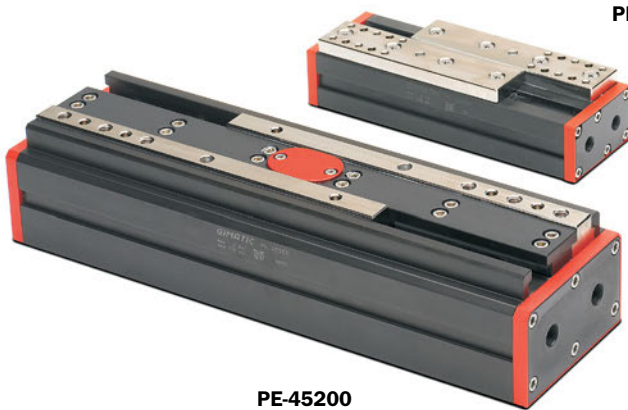

PE-45200

PE-25100



PE-25200



PE-2560



PE-2540



PE-2520



PE-16200



PE-16150



PE-1680



PE-1640



PE-1625



PE-1610

Rotary Units  
Quick Changer  
Profiles and Brackets  
Grippers  
Linear Actuators  
Suspensions  
Nippers  
Robot Kit  
Options  
Sensors

	PE-1610	PE-1625	PE-1640	PE-1680	PE-16150	PE-16200
Medium	Compressed air in compliance with ISO 8573-1:2010 [7:4:4]					
Operating pressure range	2÷8 bar					
Operating temperature range	5÷60 °C.					
Gripping force at 6 bar on each jaw	100 N					
Total gripping force at 6 bar	200 N					
Stroke	2x5 mm	2x12.5 mm	2x20 mm	2x40 mm	2x75 mm	2x100 mm
Maximum working frequency	3 Hz	2 Hz	2 Hz	2 Hz	1 Hz	1 Hz
Cycle air consumption	7 cm <sup>3</sup>	14 cm <sup>3</sup>	21 cm <sup>3</sup>	39 cm <sup>3</sup>	71 cm <sup>3</sup>	97 cm <sup>3</sup>
Closing time without load	0.02 s	0.05 s	0.1 s	0.2 s	0.4 s	0.5 s
Repetition accuracy	0.03 mm	0.03 mm	0.03 mm	0.03 mm	0.03 mm	0.03 mm
Weight	200 g	250 g	350 g	500 g	900 g	1200 g

### Gripping force

The graphs show the gripping force on each jaw, as a function of the operating pressure, the gripping tool length Z and the overhanging X.

**The force shown in these graphs refers to one jaw. The total force is double.**

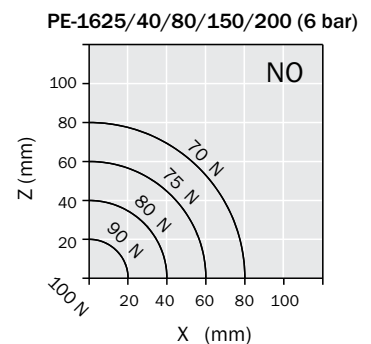
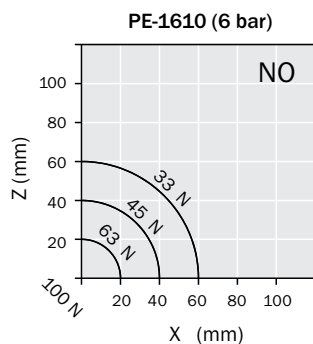
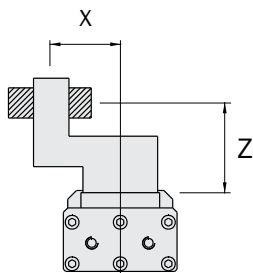
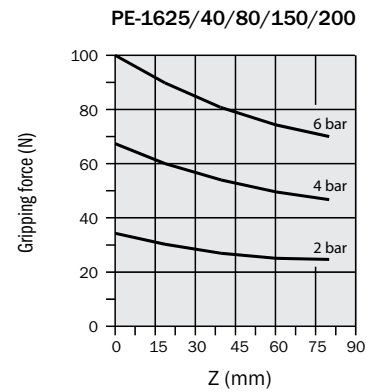
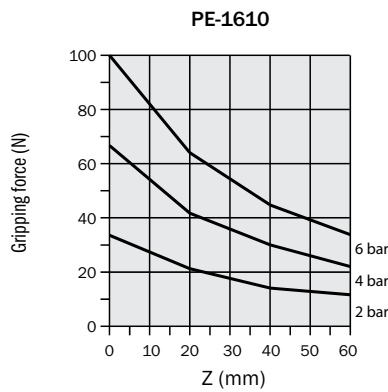
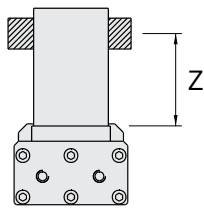

	PE-2520	PE-2540	PE-2560	PE-25100	PE-25200
Medium	Compressed air in compliance with ISO 8573-1:2010 [7:4:4]				
Operating pressure range	2÷8 bar				
Operating temperature range	5÷60 °C.				
Gripping force at 6 bar on each jaw	230 N				
Total gripping force at 6 bar	460 N				
Stroke	2x10 mm	2x20 mm	2x30 mm	2x50 mm	2x100 mm
Maximum working frequency	3 Hz	2 Hz	2 Hz	1 Hz	1 Hz
Cycle air consumption	44 cm <sup>3</sup>	74 cm <sup>3</sup>	102 cm <sup>3</sup>	146 cm <sup>3</sup>	263 cm <sup>3</sup>
Closing time without load	0.02 s	0.04 s	0.06 s	0.08 s	0.17 s
Repetition accuracy	0.04 mm	0.04 mm	0.04 mm	0.04 mm	0.04 mm
Weight	700 g	980 g	1285 g	1235 g	2080 g

**Gripping force**

The graphs show the gripping force on each jaw, as a function of the operating pressure, the gripping tool length Z and the overhanging X.

**The force shown in these graphs refers to one jaw. The total force is double.**

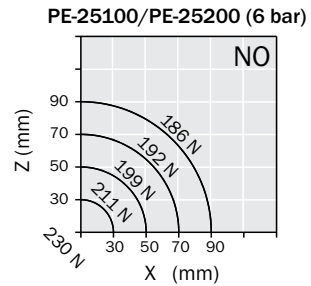
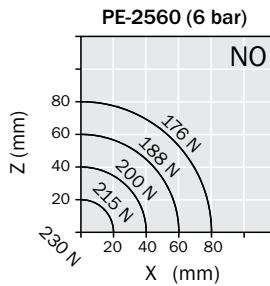
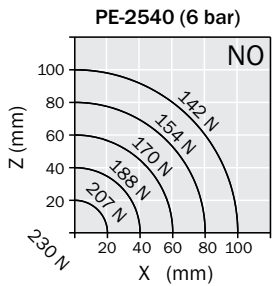
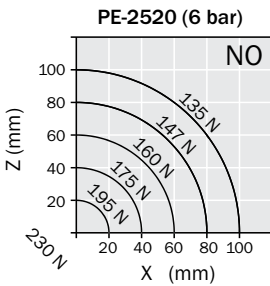
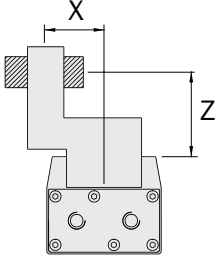
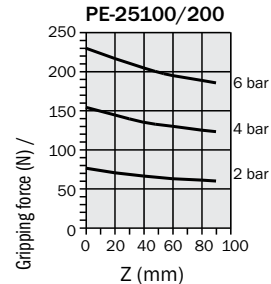
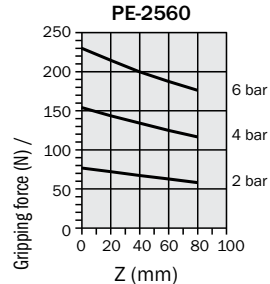
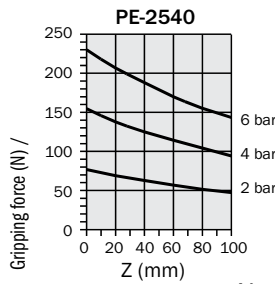
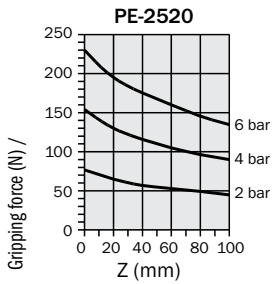
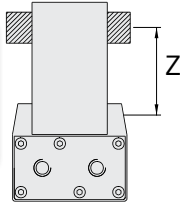

	PE-4520	PE-4540	PE-4560	PE-4580	PE-45200
Medium	Compressed air in compliance with ISO 8573-1:2010 [7:4:4]				
Operating pressure range	2÷8 bar				
Operating temperature range	5÷60 °C.				
Gripping force at 6 bar on each jaw	700 N	700 N	700 N	700 N	900 N
Total gripping force at 6 bar	1400 N	1400 N	1400 N	1400 N	1800 N
Stroke	2x10 mm	2x20 mm	2x30 mm	2x40 mm	2x100 mm
Maximum working frequency	3 Hz	2 Hz	1 Hz	1 Hz	1 Hz
Cycle air consumption	132 cm <sup>3</sup>	208 cm <sup>3</sup>	257 cm <sup>3</sup>	371 cm <sup>3</sup>	940 cm <sup>3</sup>
Closing time without load	0.05 s	0.1 s	0.15 s	0.2 s	0.2 s
Repetition accuracy	0.04 mm	0.04 mm	0.04 mm	0.04 mm	0.04 mm
Weight	1840 g	2250 g	2715 g	3300 g	3800 g

### Gripping force

The graphs show the gripping force on each jaw, as a function of the operating pressure, the gripping tool length Z and the overhanging X.

**The force shown in these graphs refers to one jaw. The total force is double.**

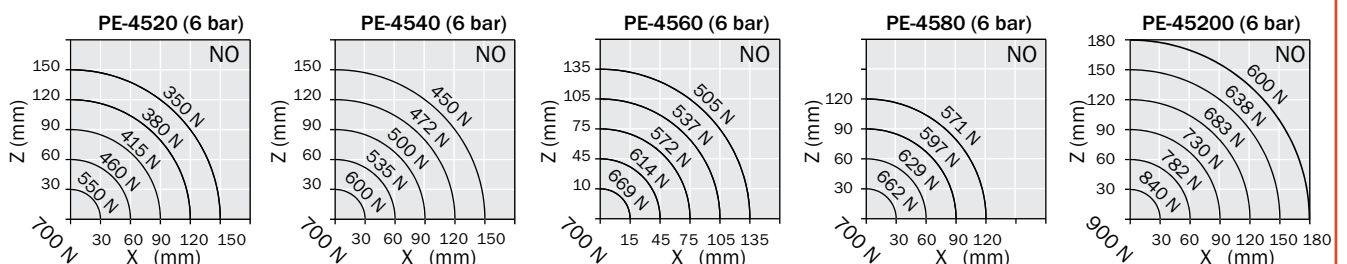
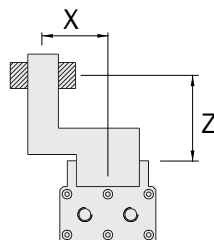
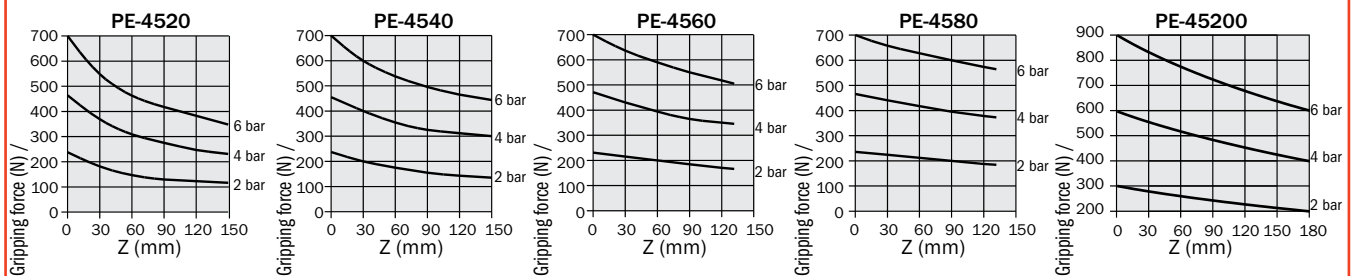
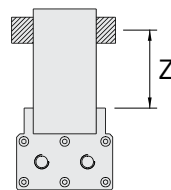

Dimensions (mm)

	A	B	C	D	E	F ±0.02	G	H	L	M	N	P	Q	R ±0.02	S ±0.02	T ±0.02	U ±0.02
PE-1610	62	60	26	37	52	44	36	29	13	36	7	11.75	31	26	27	12	7

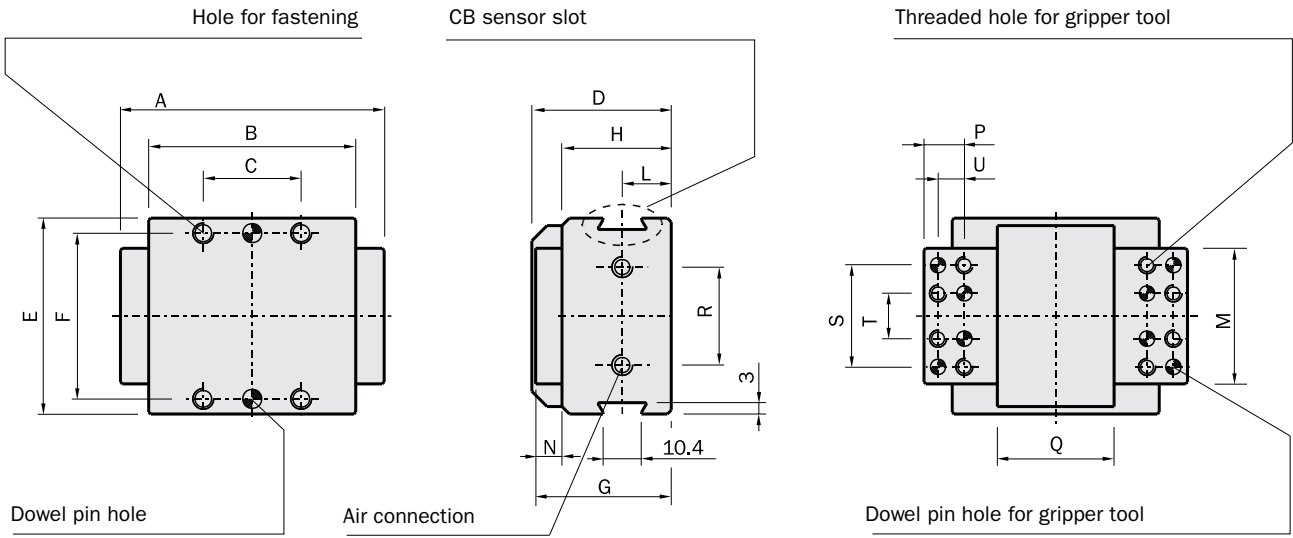

	A	B	C	D	E	F	G ±0.02	H	I	L	M	N	P ±0.02	Q	R	S	T	U	X	Z
PE-1625	70	-	-	26	24	12.5	44	5	-	12	12	48	12	37	29	13	26	52	41.5	14.5
PE-1640	99	-	-	60	24	26.5	44	5	-	8	12	48	10	37	29	13	26	52	63	15
PE-1680	155	-	-	60	24	54.5	44	5	5	8	12	48	10	37	29	13	26	52	99	15
PE-16150	263	-	200	60	24	108.5	44	5	5	8	12	48	10	37	29	13	26	52	172	15
PE-16200	337	280	200	60	24	145.5	44	5	5	8	12	48	10	37	29	13	26	52	221	15

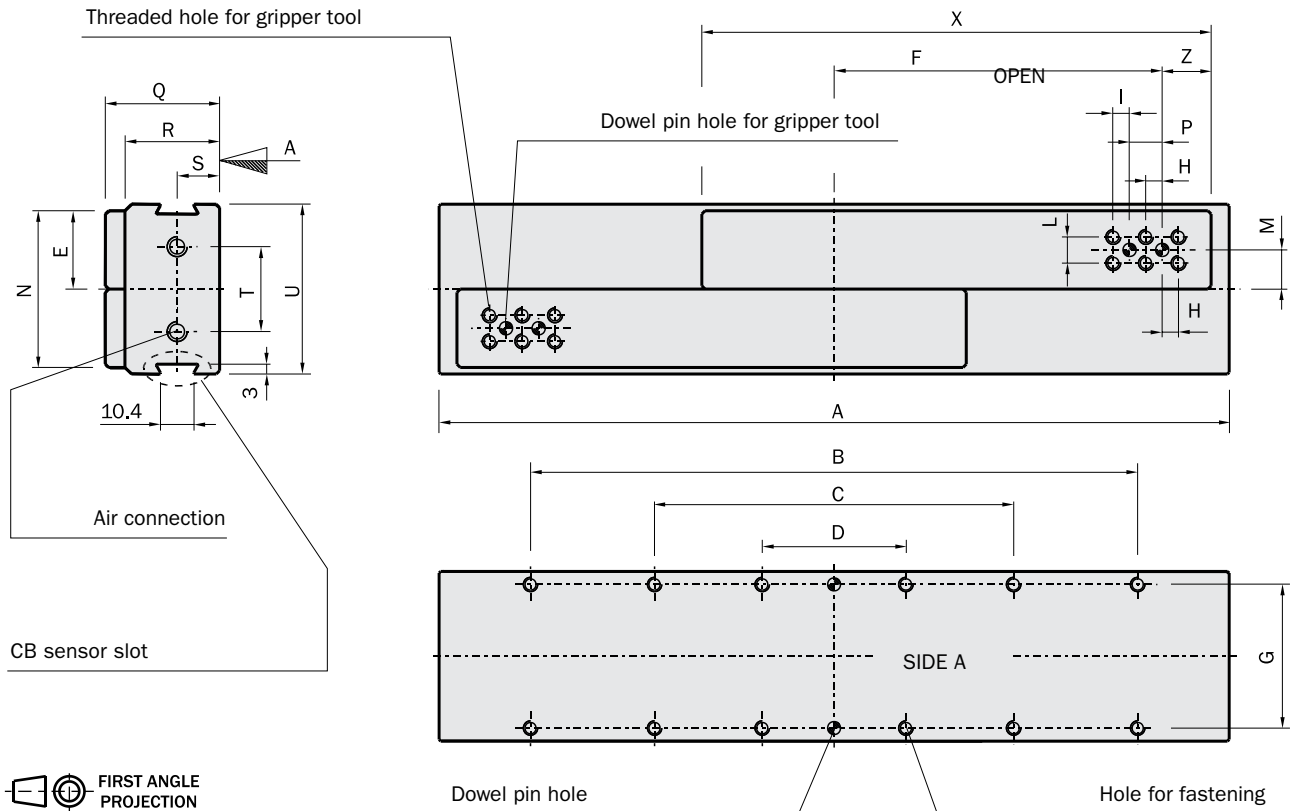

FIRST ANGLE PROJECTION

Rotary Units  
Quick Changer  
Profiles and Brackets  
Grippers  
Linear Actuators  
Suspensions  
Nippers  
Robot Kit  
Options  
Sensors

**Dimensions (mm)**

	A	B	C	D	E ±0.02	F	G ±0.02	H	I	L	M	N	P	Y	R -0.05	S -0.05
PE-2520	90	83.6	-	45	57	48.5	4.5	57	53	19.5	67	18	32	35	14	44
PE-2540	130	123.6	-	45	57	48.5	4.5	57	53	19.5	67	18	32	35	14	44
PE-2560	165	158.6	120	45	57	48.5	4.5	57	53	19.5	67	18	32	35	14	44

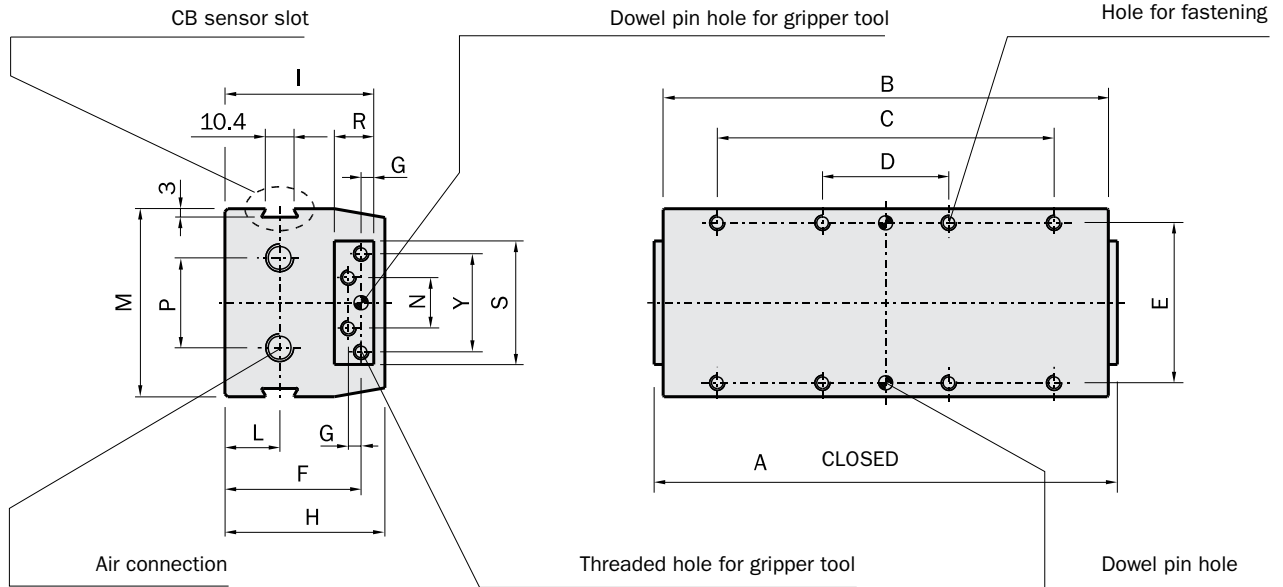

	A	B	C	D	E	F	G	H	L	M	N	P	Y ±0.02	R	S ±0.02	U	X	V
PE-25100	200.6	-	150	45	136	16	64	48.5	39	19.5	32	67	57	75	20	18	32	10
PE-25200	350.6	300	150	45	236	16	64	48.5	39	19.5	32	67	57	150	20	18	32	10

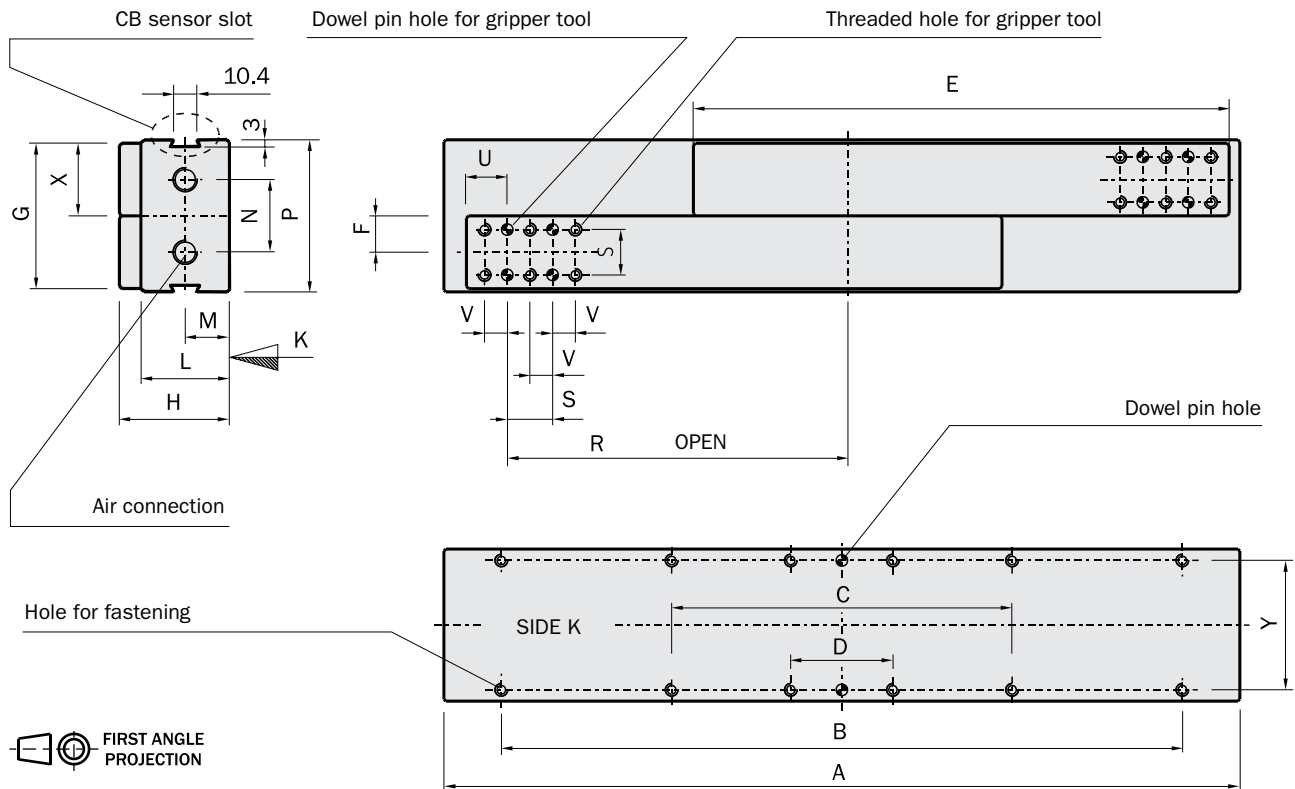

09/2022

Dimensions (mm)

	A	B	C	D -0.05	E +0.05	F	G	H	L	M	N	P	Q	R -0.05	S ±0.02	T	V	X	K	Z
PE-4520	110	100.6	50	60	10	3	6	47	72.5	60	32	34	28	25	90	83	91	104	85	49
PE-4540	140	128.6	75	60	10	3	6	47	72.5	60	32	34	28	25	90	83	91	104	85	49
PE-4560	170	160.6	90	60	10	3	6	47	72.5	60	32	34	28	25	90	83	91	104	85	49
PE-4580	210	200.6	90	60	10	3	6	47	72.5	60	32	34	28	25	90	83	91	104	85	49

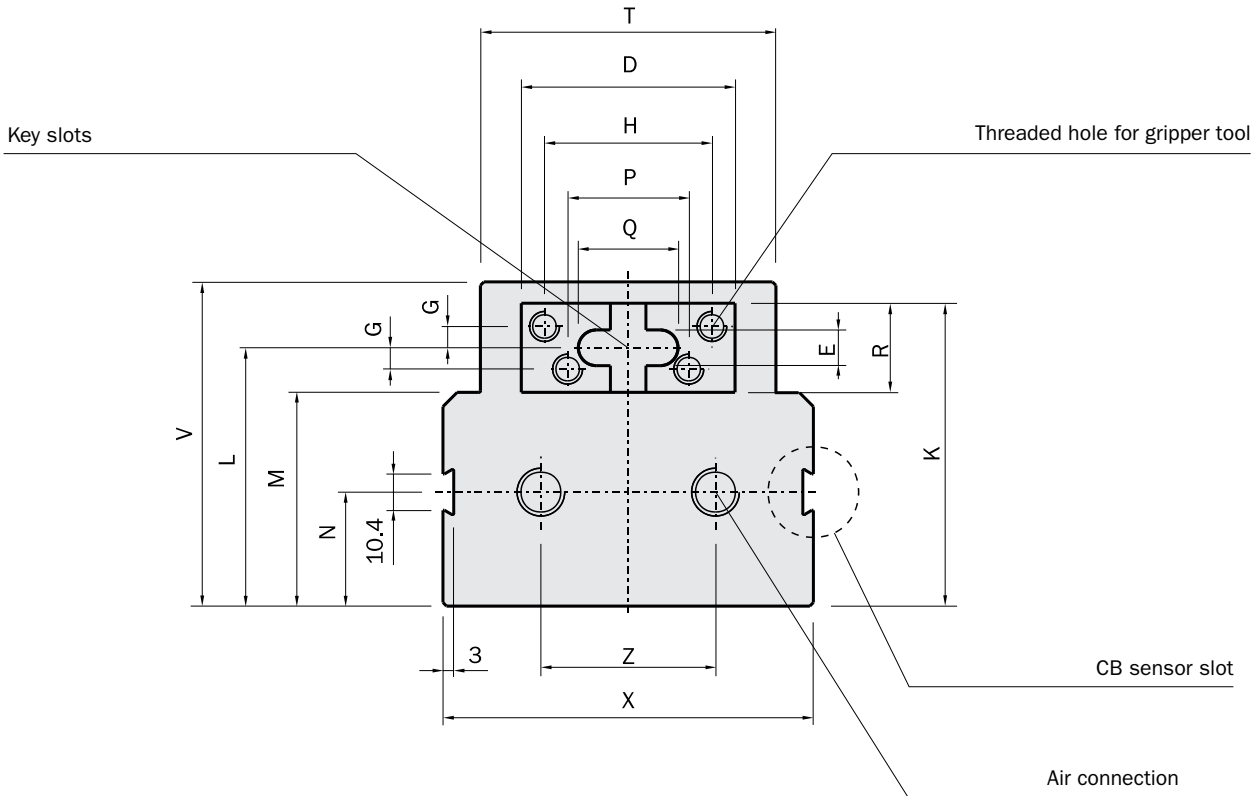
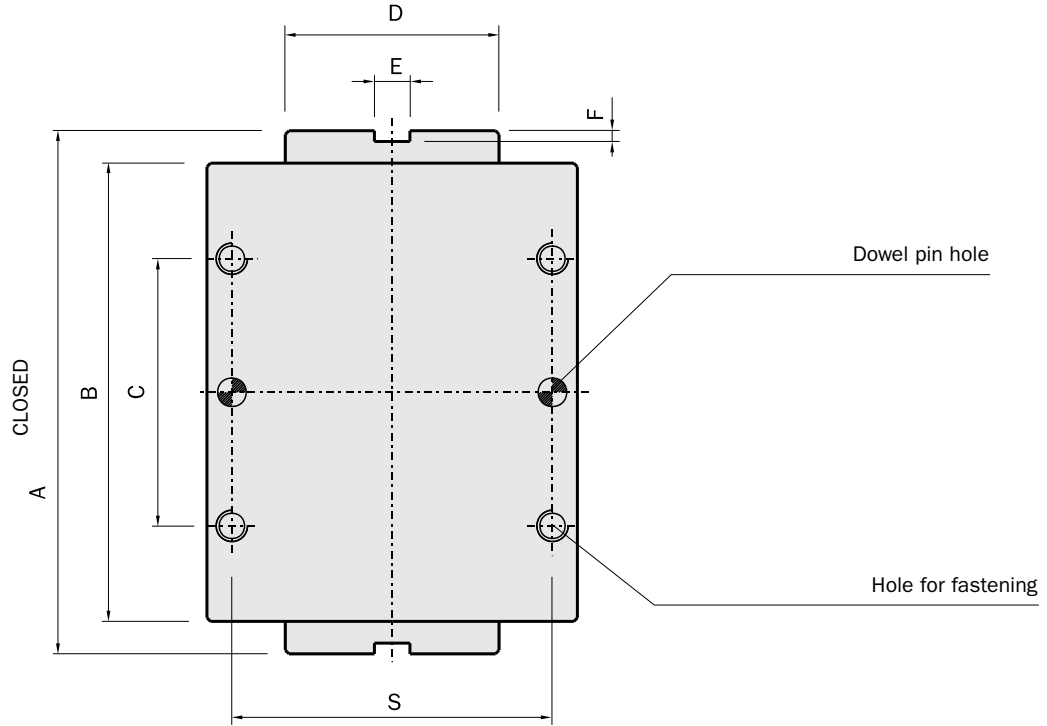

Rotary Units  
Quick Changer  
Profiles and Brackets  
Grippers  
Linear Actuators  
Suspensions  
Nippers  
Robot Kit  
Options  
Sensors

**Dimensions (mm)**

**PE-45200**

FIRST ANGLE PROJECTION

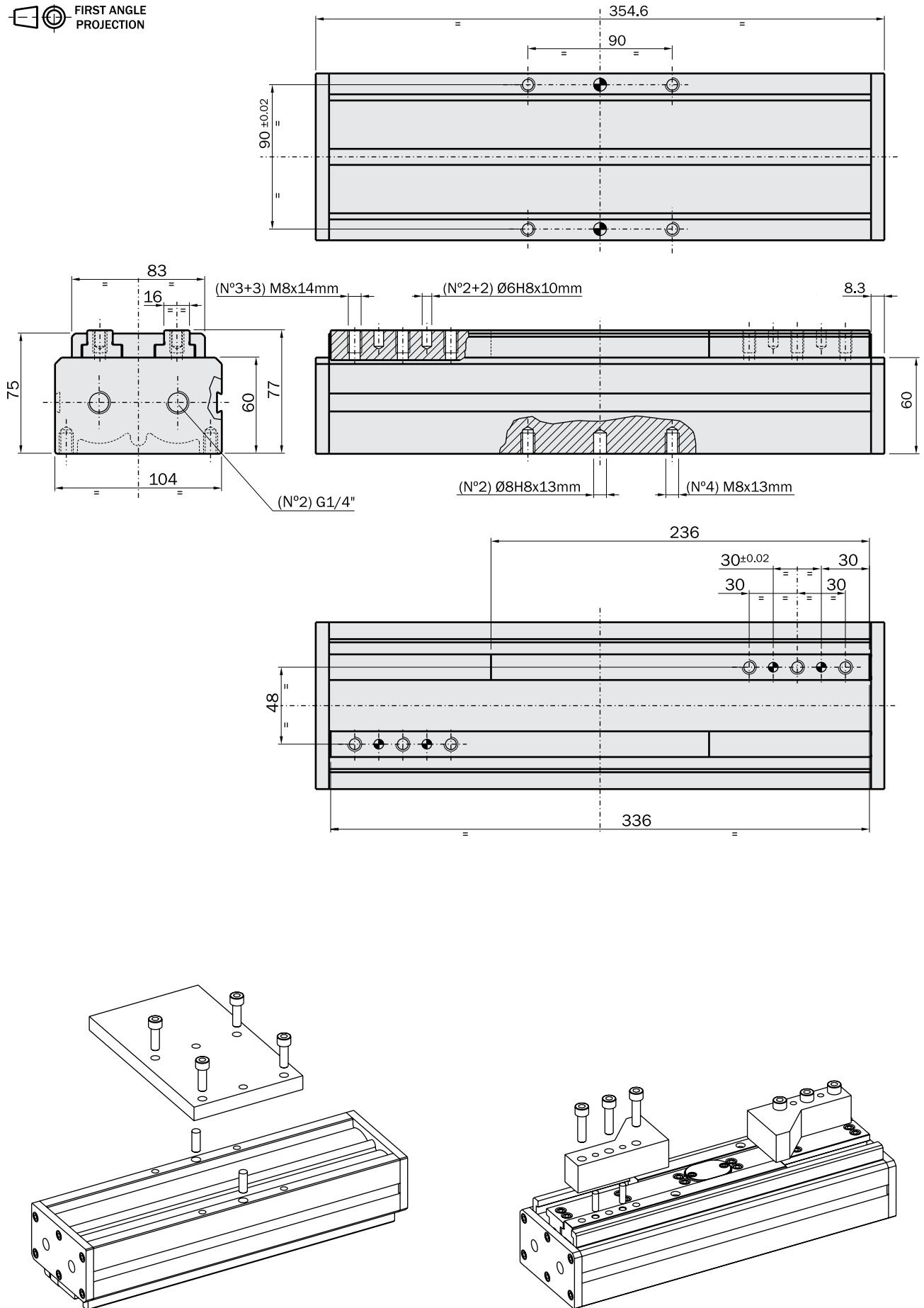

09/2022

Rotary Units

Quick Changer

Profiles and Brackets

Grippers

Linear Actuators

Suspensions

Nippers

Robot Kit

Options

Sensors