

90° Double Acting Gripper Fingers

- Find extensions on page 529.
- As a safety feature, GFD gripper fingers will lock in the closed position (90°) until the release port is supplied with air pressure.
- Programmable sensor (#3809) for detection of two positions on page 1005.

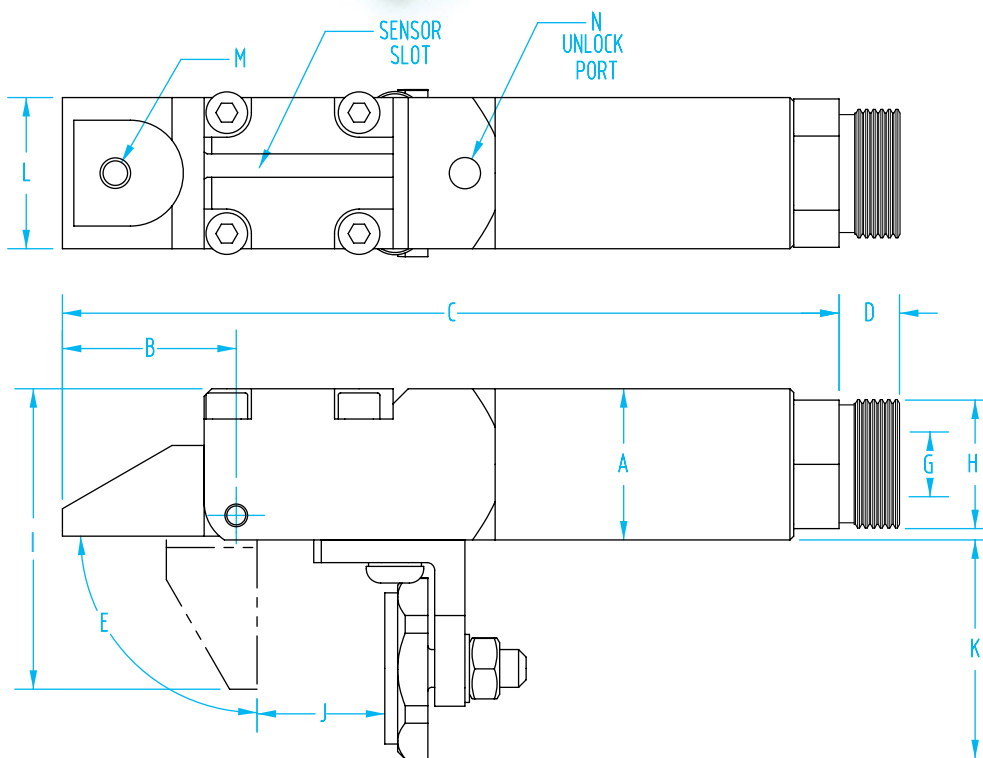

NEW

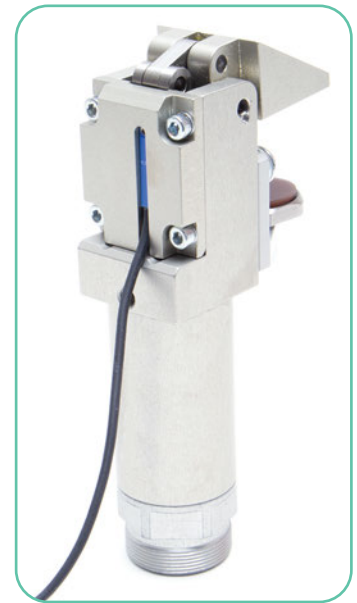
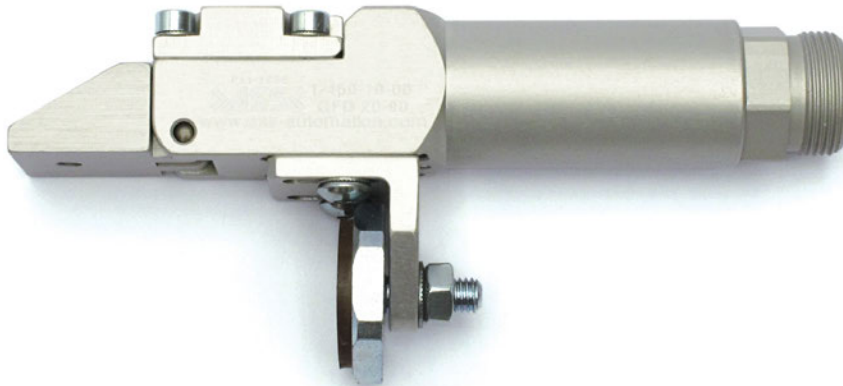

90° Double Acting Gripper Finger

Quick#	Part#	>ASS<#	Price	ØA	B	C	D	E	G	H	I	J	K	L	M	N	Closing force*	Wt.
3639	GFD20-90	1-450-10-00	\$470.40	20	23	103	8	90°	G1/8"	M17x1	40	0-34	28	20	M4	M5	24 lbf	100g
3922	GFD-20-90-EP90	1-450-11-00	\$535.50	23	23	103	8	90°	G1/8"	M17x1	40	0-34	28	20	M4	M5	24 lbf	100g
3640	GFD30-90	1-450-24-00	\$485.10	30	32	134	11	90°	G1/8"	M27x1	57	0-46	28	30	M5	M5	36 lbf	270g
3923	GFD-30-90-EP90	1-450-30-00	\$563.85	30	32	134	11	90°	G1/8"	M27x1	57	0-46	28	30	M5	M5	36 lbf	270g

Maximum continuous temperature for Rubber pad is 160°F. For EP coating is 194°F with a short term max temp of 266°F.

*Force at 87 psi (6 bar)