

EOAT Mounting Plate for Large Size (150mm) Quick Changers

(Dimensioned drawing shown half scale)

Use with **150mm Quick Changers** to Mount to >ASS<, Gimatic, and 80/20 Profile

Typically used when the injection molding machine is over 750 tons, this plate is designed to mount large/jumbo >ASS<, Gimatic, and 80/20 four- and six-groove profiles (80mmx40mm) as well as all standard profile. It is pre-drilled to mount to the large EOAT quick changer. The counter-bored holes provide flush mounting surfaces on both sides. And it can also be used as a manual mounting plate to the robot.

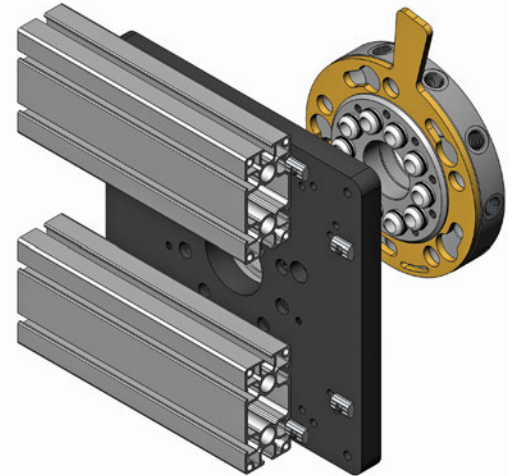

Large Size (150mm) EOAT Mounting Plate

Quick#	Part#	Wt.	Price	Description
1817	GSC-QCAP-L	2094g	\$99.00	Fasteners on page 1077

Note: Can also be used with Gimatic QC-160

- Ⓐ 40mm spacing for >ASS< 80mm X 40mm "J" profiles. Use: #874 M6 x 16mm SHCS, #880 lock washer, & #3031 M6 T nut.

- Ⓑ 25mm spacing for >ASS< 50mm X 25mm "X" profiles and 80/20 1020 profiles. Use #854 M5 x 12mm SHCS, #865 lock washer, & #3030 M5 T nut.

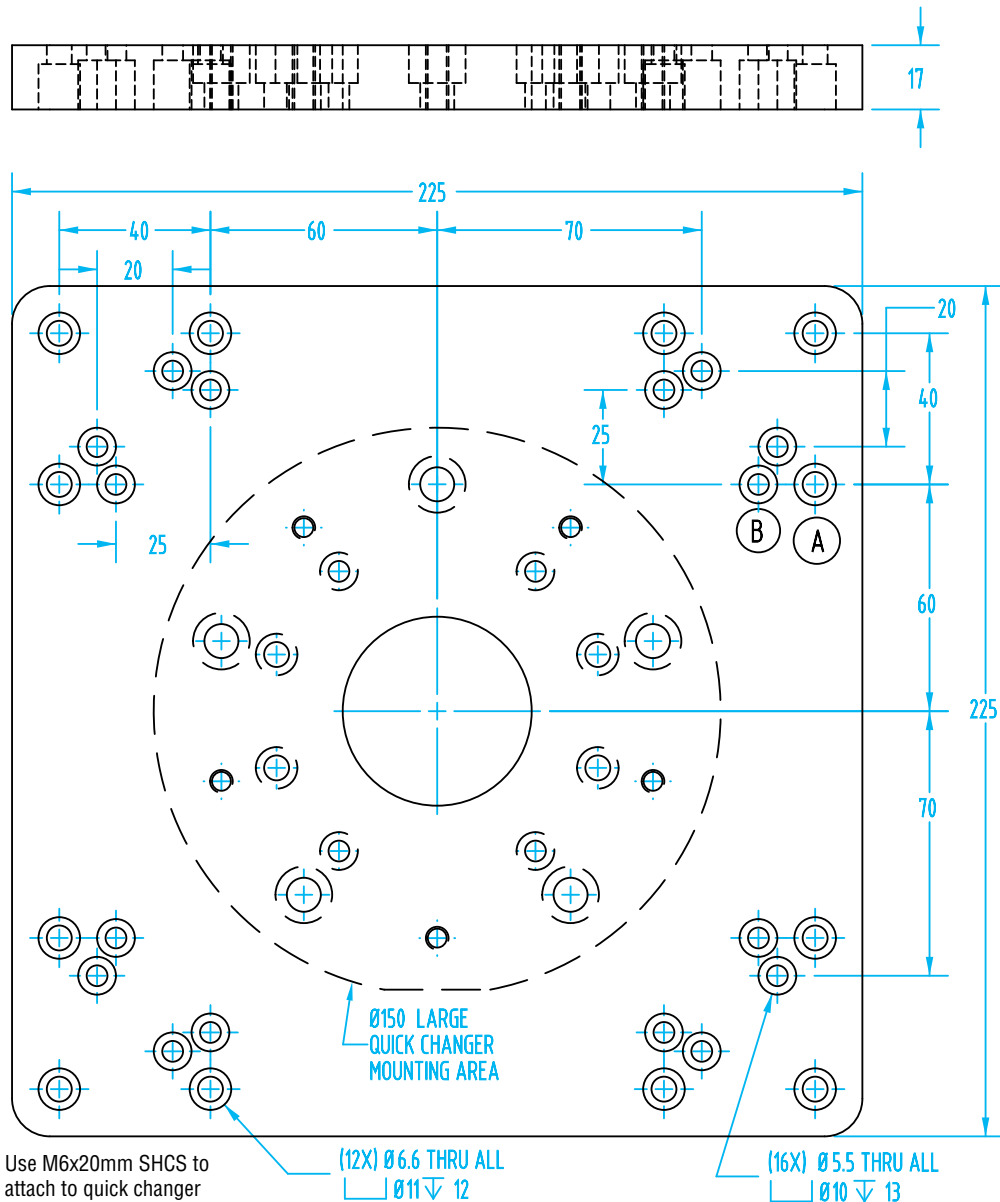

Blank EOAT Mounting Plate for Large Size (150mm) Quick Changers

(Dimensioned drawing shown half scale)

Basic Blank Mounting Plate for Custom Mount

This anodized aluminum plate can be used as a manual EOAT mounting plate to adapt profiles as shown on page 44. It is scored with a center line making it easy to locate holes for mounting to your robot tooling plate. There is plenty of space on this plate to drill or tap holes as necessary. Pre-drilled and counter-bored holes simplify mounting of two-, four-, and six-groove profiles.

Save on Custom Plates!

Custom mounting plates, interfaces, and brackets for building EOAT are available from EMI – Fast and at a low cost. EMI's in-house laser cutter precision cuts aluminum and stainless up to 0.250" thick.

(A) 40mm spacing for >ASS< 80mm X 40mm "J" profiles. Use: #874 M6 x 16mm SHCS, #880 lock washer, & #3031 M6 T nut.

(B) 25mm spacing for >ASS< 50mm X 25mm "X" profiles and 80/20 1020 profiles. Use #854 M5 x 12mm SHCS, #865 lock washer, & #3030 M5 T nut.

Large Size (150mm) EOAT Mounting Plate

Quick#	Part#	Wt.	Price	Note
760	GSC-QCAP-LB	2230g	\$98.40	Fasteners on page 1077

