

# EJ-LARGE cartridges for integration

## EJ-LARGE-HV-2

- Two-stage EJ-LARGE-HV-2 cartridge with compact dimensions
- Can be integrated near the gripping point
- Suitable for handling sealed objects, while being effective on porous products thanks to the high suction flow rate (between -30 and -50 kPa)
- Fast response times at high vacuum levels
- Maximum vacuum level (-94 kPa)
- Available in the cartridge-only or cartridge with holder and integrated silencer versions



### Technical features

Max feed pressure	0.7 MPa
Temperature range	+14 - +176 °F
Weight	15.3 ÷ 68.7 g

### Suction flow rate

Feed pressure [MPa]	Air consumption [l/s]	Suction flow rate [l/s] at different vacuum levels [kPa]										Max vacuum [kPa]
		0	-10	-20	-30	-40	-50	-60	-70	-80	-90	
0.45	1.82	2.8	2.3	1.7	1.0	0.70	0.58	0.40	0.31	0.18	0.03	-90
0.5	1.93	2.6	2.4	1.7	1.3	0.70	0.55	0.40	0.31	0.15	0.02	-94
0.6	2.33	2.7	2.4	2.0	1.6	1.03	0.68	0.36	0.30	0.14	0.02	-92

### Evacuation time

Feed pressure [MPa]	Air consumption [l/s]	Evacuation time [s/l] to reach different vacuum levels [kPa]										Max vacuum [kPa]
		-10	-20	-30	-40	-50	-60	-70	-80	-90		
0.45	1.82	0.04	0.08	0.13	0.2	0.4	0.5	0.7	1.0	2.3	-90	
0.5	1.93	0.04	0.09	0.16	0.3	0.4	0.6	0.9	1.3	2.5	-94	
0.6	2.33	0.04	0.08	0.14	0.2	0.3	0.5	0.8	1.3	2.3	-92	

**Identification codes**

Drawing	Alphanumeric code	Description	Order code
A	EJ-L-HV-2	EJ-LARGE-HV-2 without holder	3300049
B	EJ-L-HV-2-HS	EJ-LARGE-HV-2 with holder and integrated silencer	3300050
C	EJ-L-HV-2-NR	EJ-LARGE-HV-2 with non-return valve	3300051
D	EJ-L-HV-2-NR-HS	EJ-LARGE-HV-2 with holder, integrated silencer and non-return valve	3300052
E	EJ-L-HV-2-H	EJ-LARGE-HV-2 with holder	3300063



**Click for Pricing & Add to Cart**

A C

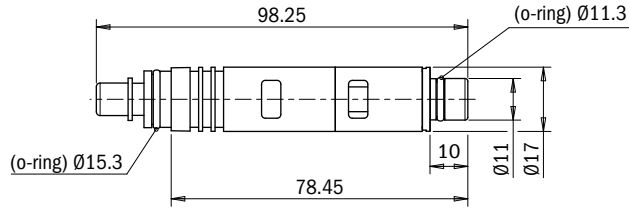

B D

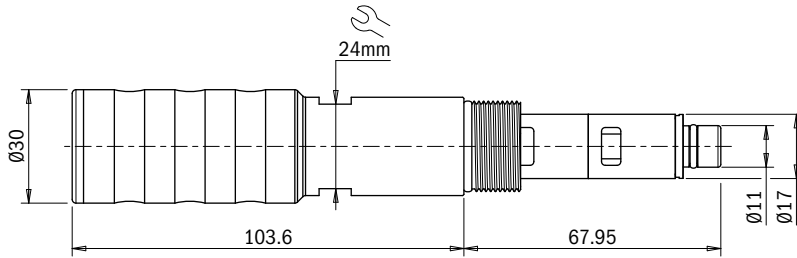

E

