

## Cleanroom Gripping Solution







Gimatic electric grippers can operate in environments characterised by a high standard of cleanliness and hygiene by integrating the KIT-GMPLM3240. An adapter enables fastening the electric gripper to a robot interface (not included) and protecting its operation by means of a sterilisable silicone cover. The gripping fingers (not included) can be fastened by means of special hygienic stainless steel screws. The systems meets the most stringent GMP (Good Manufacturing Practice) cleanliness standards for Grade A and B.

Its main characteristics are:

- Suitable for the MPLM3240 (1), MPLF3270 (2) and MPCF3270 (3) grippers.
- Compliant with GMP Grade A and B cleanliness standards.
- Cover made in Silicone Silpuran® Wacker FDA 21 CFR §177.2600.
- Compatible with hydrogen peroxide (VHP-H<sub>2</sub>O<sub>2</sub>) and UV cleaning procedures.
- Complete system with IP65 protection rating.
- ISO14644-1 certification for ISO 5 cleanrooms.
- Stainless steel hygienic screws (Novonox).
- Transparent surface that enables reading the LEDs of the internal sensors and the power supply status LEDs.
- Hygienic design surfaces preventing the build-up of bacteria.
- Easy fastening of gripping fingers with anti-rotation system.

[Click for Pricing & Add to Cart](#)



 <p><b>KIT-GMPLM3240</b></p>	(1)	 <p><b>MPLM3240</b></p>	+	 <p><b>MPLM32-KIT-02</b></p>
	(2)	 <p><b>MPLF3270</b></p>	+	 <p><b>MPLF-KIT-02</b></p>
	(3)	 <p><b>MPCF3270</b></p>	+	 <p><b>MPCF-KIT-01</b></p>

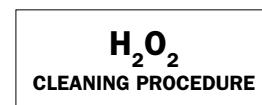



## Assembly

- Mount the gripper (not included in the KIT-GMPLM3240 box) onto the gripper interface using the hex socket head cap screws and the centering sleeves included in the box and forming the gripper subsystem.

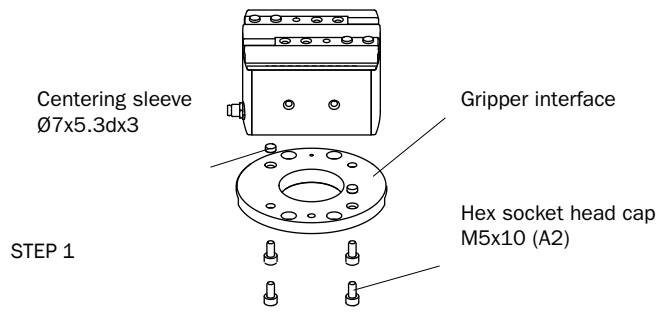

- Connect the female M8 connector to the gripper and eventually drive the cable below the gripper interface along the central groove of the robot interface (depending on the application constraint and commissioning of the robot).
- Fix gripper subsystem onto the robot interface using the screws and the centering pin forming the gripper subassembly.
- Maximum clamping torque of the screws = 1.5 Nm.

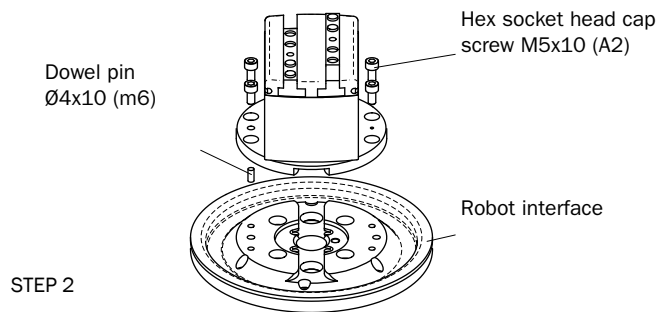

- Fix the internal jaws and the spacers using the cross recessed countersunk head screws and the centering sleeves included in the box.

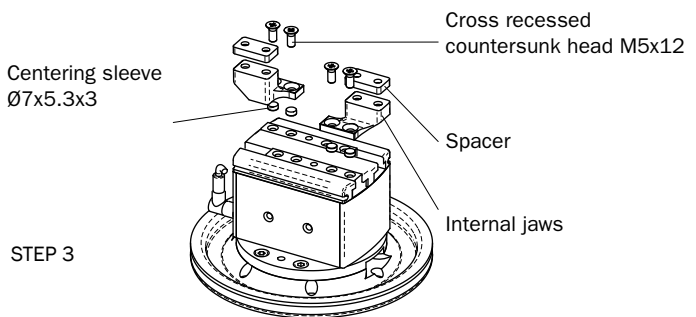

- Finally, install the silicon cover and the external pins. Pay attention the silicon cover is correctly in place inside the circular groove of the robot interface all around the part.

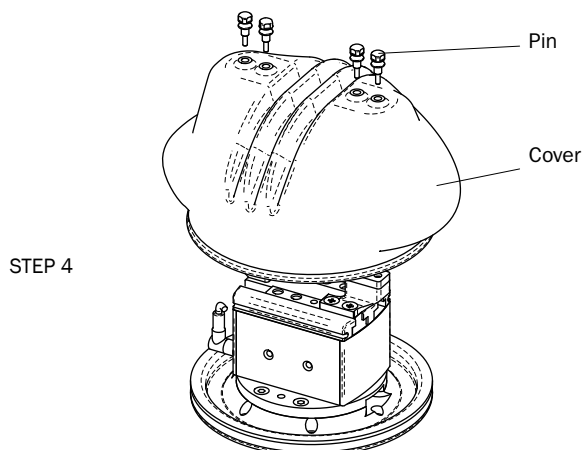

**Part list**

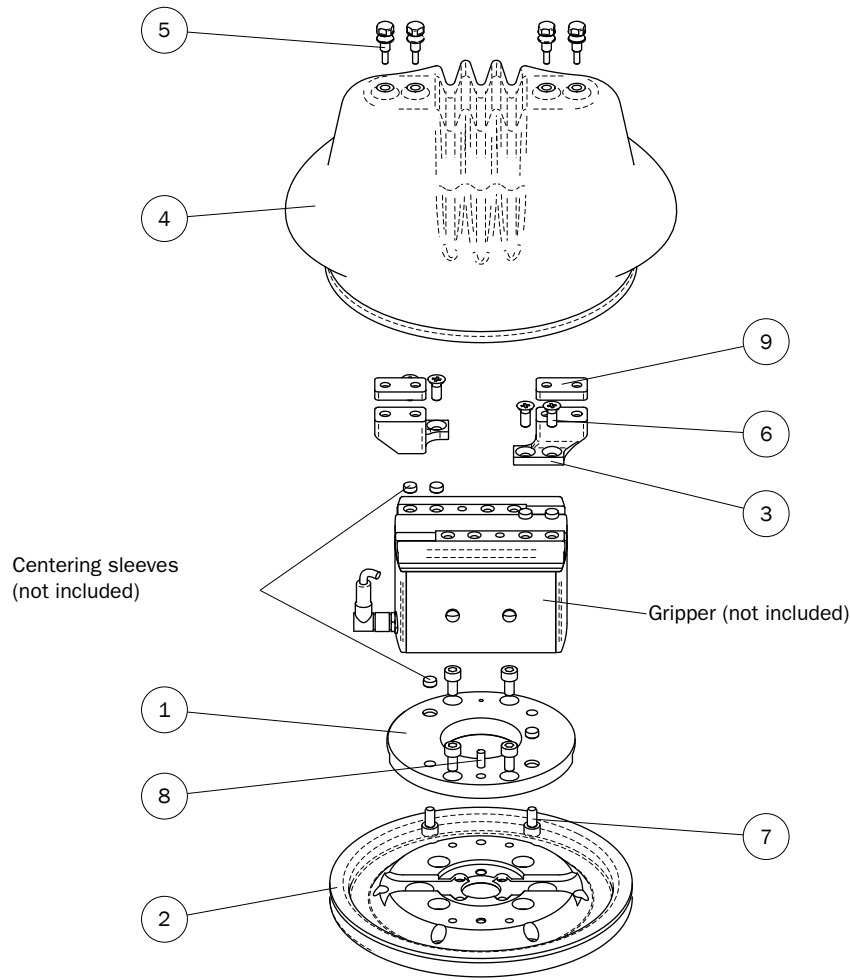

**Included parts**

Part No.	Description	Quantity	Weight	Order No.
1	Gripper interface	1	120 g	1
2	Robot interface	1	400 g	2
3	Internal jaws	2	20 g	3
4	Cover	1	152 g	4
5	Pin	4	5.3 g	5
6	Cross recessed flat countersunk head m5x12 inox a2	4	2 g	6
7	Hex socket head cap M5x10 inox a2	8	2.9 g	7
8	Dowel pin ø4x10 (m6)	1	1.5 g	8
9	Spacer	2	1 g	9

**CE Marking reference**

The system is in conformance with:

Directive 2004/108/CE, EN 62233 (2008-04), EN 61000-6-2+EC+IS1 (2005-08; 2005-09; 2005-11), EN 61000-6-3+A1 (2007-01; 2011-03), EN 61000-6-4 (2007-01), EN 55016-2-1+A1 (2004-10; 2005-08), EN 55016-2-3 (2006-12), EN 61000-4-2 (2009-03), EN 61000-4-3+A1+IS1+A2 (2006-05; 2008-02; 2009-02; 2010-07), EN 61000-4-4+A1 (2004-12; 2010-03), EN 61000-4-5 (2006-11), EN 61000-4-6+A1+IS1 (1996-07; 2001-12; 2004-07), EN 61000-4-6 (2009-03), CEI EN 60529 (1997-06).

**IPA Certification reference**

The system has been declared suitable for use in hygienic areas by Fraunhofer IPA Institute as stated in report No. GI 1904-1109.