

## GR Gravity Roller Conveyor - Exploded View

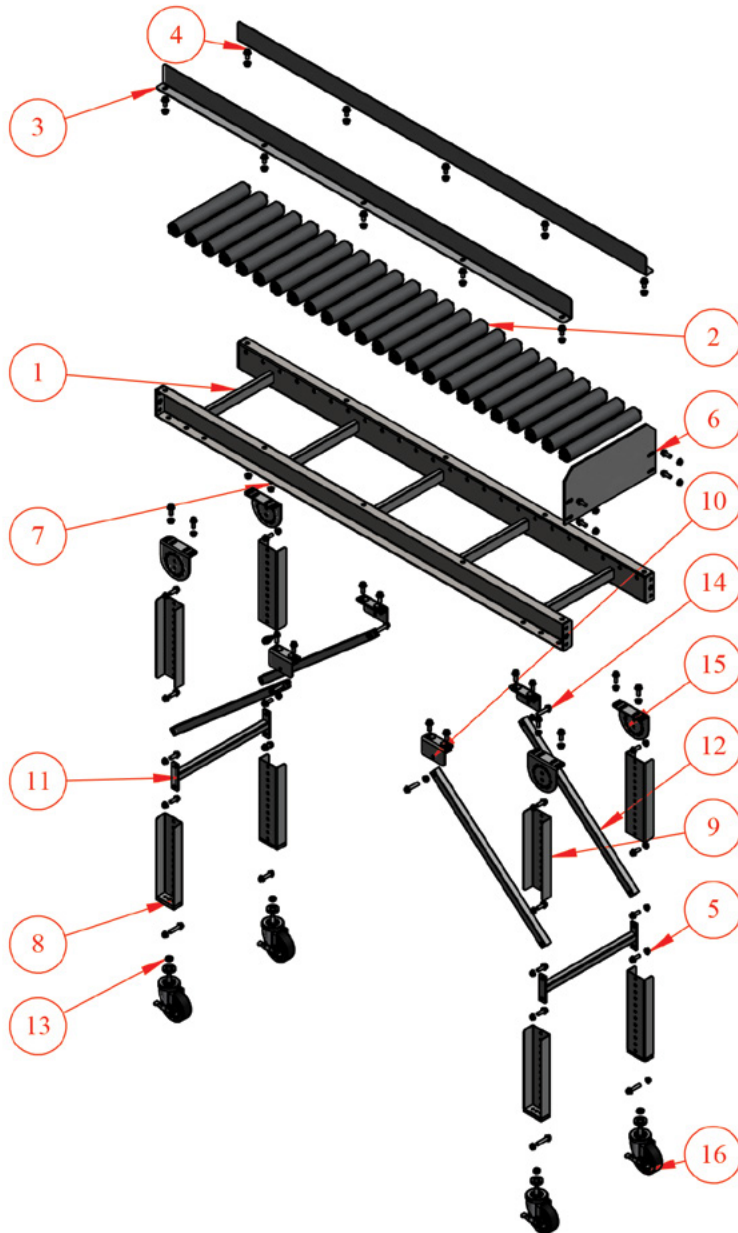

NO.	QTY	PART NO.	DESCRIPTION
1	1	6E-206-26-12	6' GRAVITY CONV.
2	24	CP-2343-G	R1916-13-A10-V03 GALVANIZE ROLLER NUMBER
3	2	6E-33-16	6' SIDE RAIL FOR GR
4	10	CP-2890	HEX SERRATED FLANGE SCREW 0.375-16x0.750" ZINC PLATED
5	47	CP-2869	SERRATED FLANGE NUT 0.375-16 ZINC PLATED
6	1	6E-93-3-12	BOX STOP
7	36	CP-2939	HEX SERRATED FLANGE SCREW 0.375-16x1.000" ZINC PLATED
8	4	2E-236-8	12" LEG WELD ASSY
9	4	2E-36-3	12" LEG EXTENSION
10	4	4E-241-2	LEG BRACE SUPPORT
11	2	3T-241-1-12	LEG BRACE WELD ASSY
12	4	4E-41-5	LEG TO FRAME BRACE
13	4	CP-508	HEX JAM NUT .500-13
14	8	CP-2940	HEX SERRATED FLANGE SCREW 0.375-16x1.750" ZINC PLATED
15	4	2M-14-16	LEG MOUNTING BRACKET
16	4	CP-1239	SWIVEL CASTER, 4"X1 3/8"

Part numbers listed in this document are for reference only. When buying replacement parts please provide your conveyor model & serial number to ensure the correct part.