

LPGR Low-Profile Gravity Roller Conveyor - Exploded View

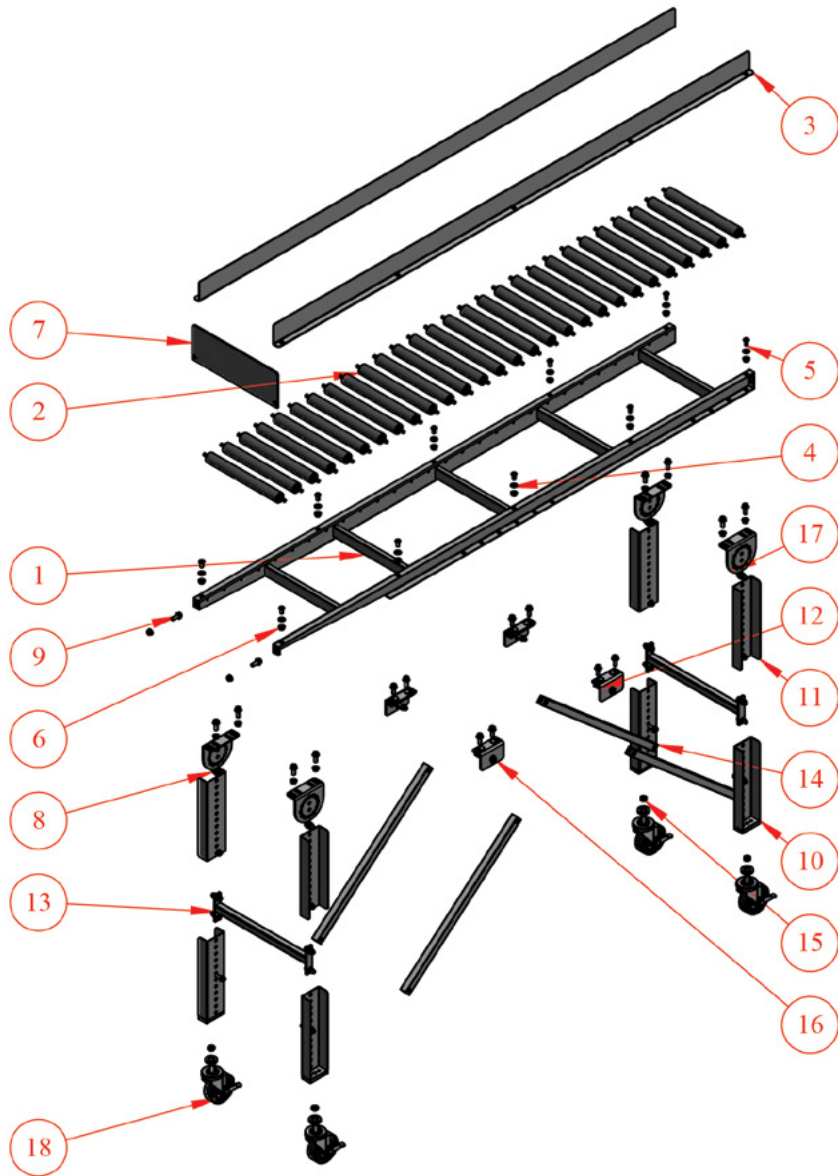

NO.	QTY	PART NO.	DESCRIPTION
1	1	6E-206-39-12-7	LOW PROFILE GRAVITY CONV.
2	28	CP-3879	5/16 HEX GRAVITY ROLLER 13"BF
3	2	6E-33-26-7	3" RAIL FOR LOW PROFILE GRAVITY
4	10	CP-3342	FLAT WASHER .375
5	10	CP-3293	HEX SOCKET BUTTON HEAD SCREW .375-16 x .750
6	10	CP-3299	3/8-16 SERRATED FLANGE
7	1	6E-93-7-12	BOX STOP
8	34	CP-2869	SERRATED FLANGE NUT 0.375-16 ZINC PLATED
9	34	CP-2939	HEX SERRATED FLANGE SCREW 0.375-16x1.000" ZINC PLATED
10	4	2E-236-8	12" LEG WELD ASSY
11	4	2E-36-3	12" LEG EXTENSION
12	4	4E-241-2	LEG BRACE SUPPORT
13	2	3T-241-1-12	LEG BRACE WELD ASSY
14	4	4E-41-5	LEG TO FRAME BRACE
15	4	CP-508	HEX JAM NUT .500-13
16	8	CP-2940	HEX SERRATED FLANGE SCREW 0.375-16x1.750" ZINC PLATED
17	4	2M-14-16	LEG MOUNTING BRACKET
18	4	CP-1239	SWIVEL CASTER, 4"X1 3/8"

Part numbers listed in this document are for reference only. When buying replacement parts please provide your conveyor model & serial number to ensure the correct part.