

SNO65 Merit Line Conveyor - Exploded View

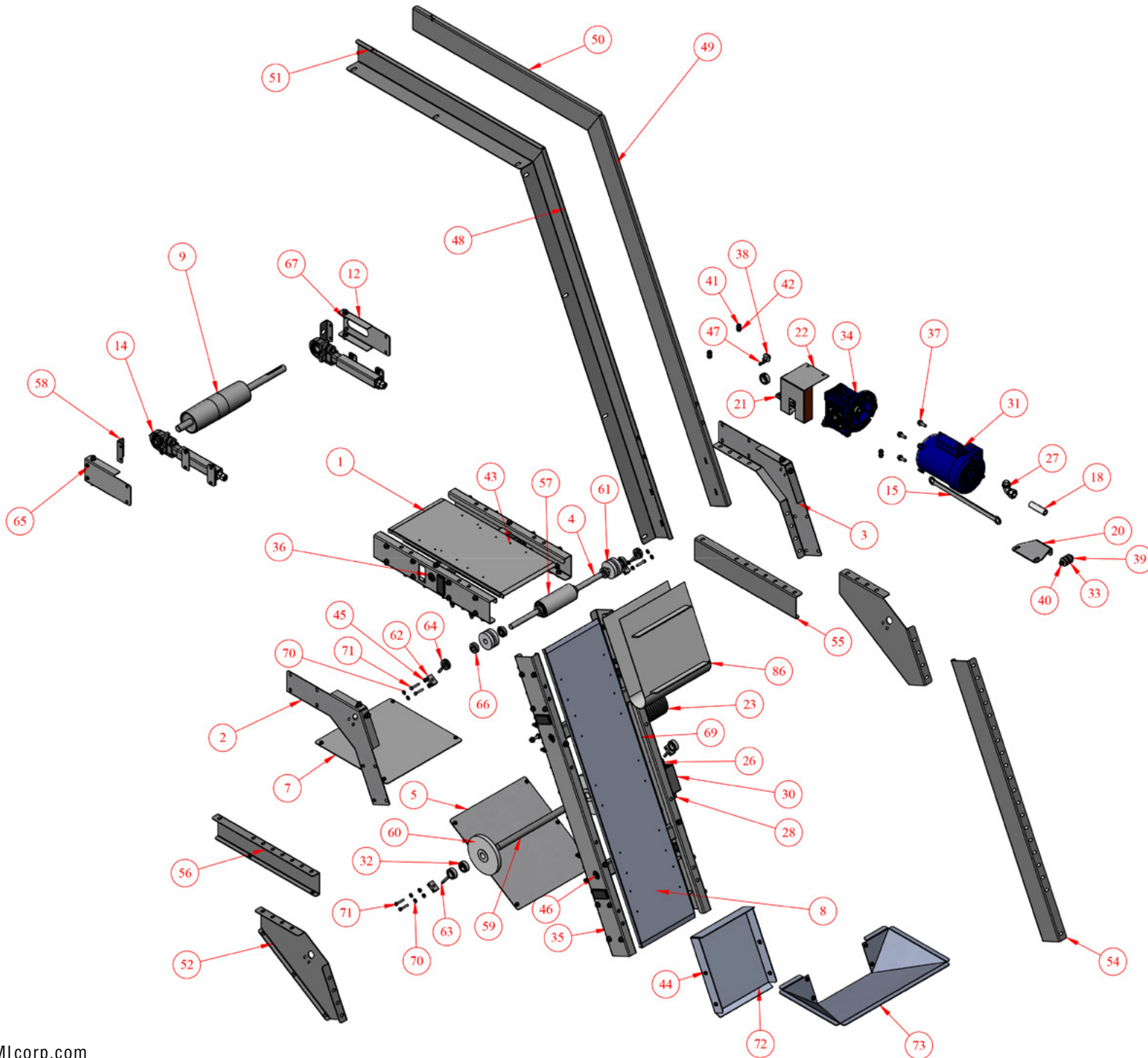

SNO65 Merit Line Conveyor - Exploded View

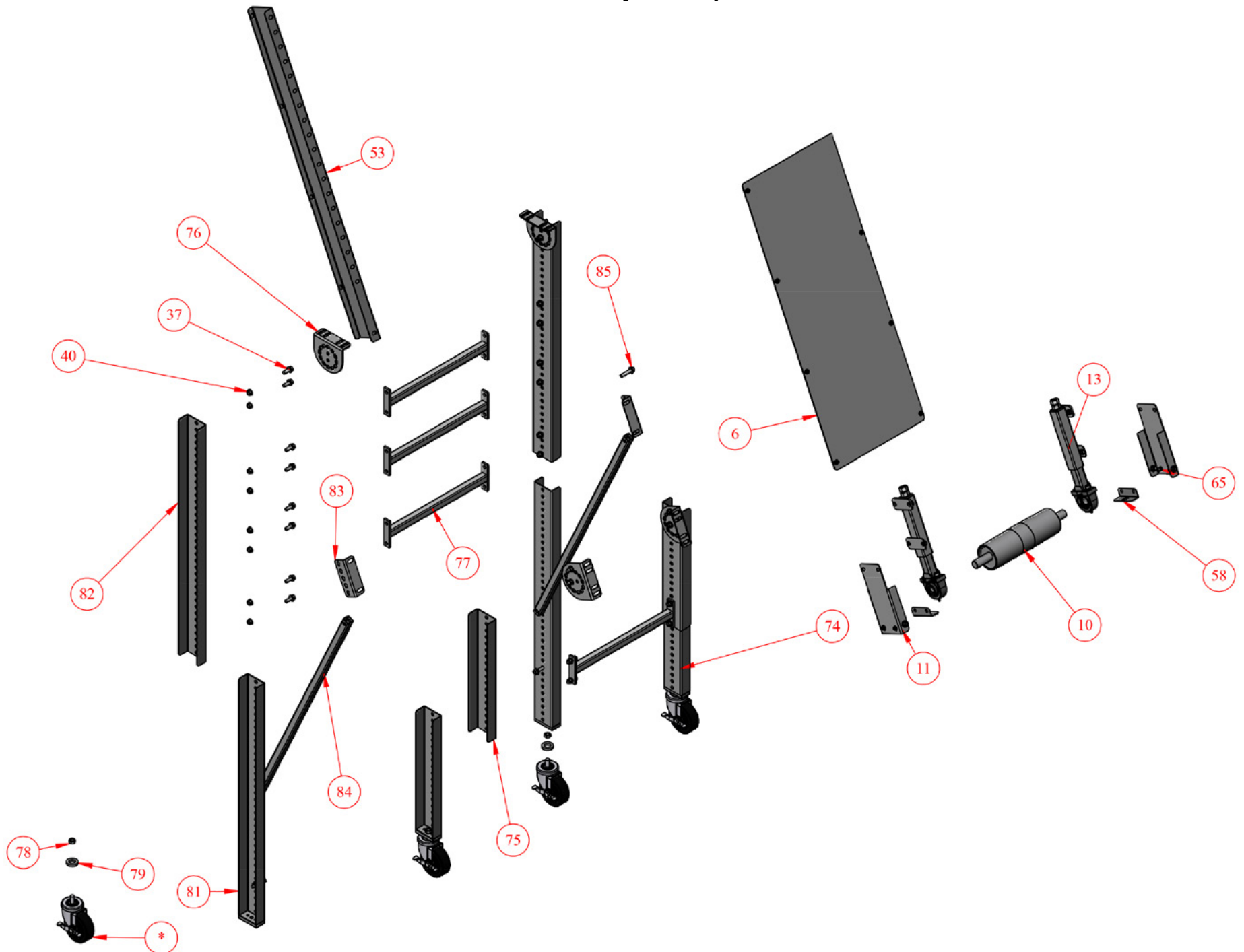

SNO65 Merit Line Conveyor - Exploded View

NO.	QTY.	PART NO.	DESCRIPTION
1	1	2M-206-L-W-DV	DD FRAME WELD ASSY.
2	1	ACN-244-1-(L/R)	65 DEG TRANSITION SIDE ASS'Y
3	1	ACN-244-1-(L/R)	65 DEG TRANSITION SIDE ASS'Y
4	1	ACN-21-1-W	TOP TRANSITION IDLER ROLLER
5	1	ACN-08-1-W	BOTTOM BELT GUARD FOR TRANS.
6	1	SNO-08-1-W-L	BOTTOM BELT GUARD FOR INCLINE
7	1	SNO-08-1-W-L	BOTTOM BELT GUARD FOR INCLINE
8	1	2M-206-L-W-DV	4' x 12" DD FRAME WELD ASSY.
9	1	4M-210-6-W	WELD ASSY FOR STEEL DRIVE
10	1	4M-224-2-W	WELD ASSY FOR STEEL TAIL
11	3	2M-08-1	PULLEY GUARD
12	1	2M-08-2	DRIVE SIDE PULLEY GUARD
13	2	2M-232-3	TAKE-UP
14	2	2M-232-4	TAKE-UP
15	1	2M-38-1	REACTION ROD
16	1	4E-269-1	BLACK WIRE ASSY FOR STD DRIVE PAK
17	1	4E-269-2	GREEN WIRE ASSY FOR STD DRIVE PAK
18	1	4E-62-1	CONDUIT FOR STD DRV PAK
19	1	2M-14-3	FG-5 SWITCH MOUNTING BRACKET
20	1	2M-14-29	REACTION ROD BRACKET
21	1	2M-14-28-1	REACTION ROD BRACKET
22	1	2M-08-12	050 MOTOVARIO GEARBOX OUTPUT SHAFT GUARD
23	1	2E-263-1	15' POWER CORD
24	1	EL-533	SQ.D. HEATER A9.85
25	3	EL-455	WIRE NUT "Y" TYPE
26	1	EL-358	APPLETON CORD GRIP CONNECTOR #CG-3150
27	1	EL-353	90 DEG .500 INCH CONDUIT FITTING (REF RACO)
28	1	EL-354	.500 INCH STRAIGHT CONNECTOR
29	3	EL-301	RING TERMINAL 14-16 AWG, #8 (STUD)

Part numbers listed in this document are for reference only. When buying replacement parts please provide your conveyor model & serial number to ensure the correct part.

SNO65 Merit Line Conveyor - Exploded View

NO.	QTY.	PART NO.	DESCRIPTION
30	1	EL-168	SWITCH - FG5 SQ. D.
31	1	EL-116B	LINCOLN LM24598 1/3 HP 115/230/60/1
32	5	CP-1201	LOCKING COLLAR 1.000IDx1.625ODx.625TH
33	2	CP-3178	UNIVERSAL MOUNT (NARROW) #60166-4
34	1	CP-3290	MOTOVARIO GEAR REDUCER #NMRV050-40-56C
35	6	CP-1581	1 1/2 x 3" BLACK PLASTIC CAP
36	2	EL-394	HEYCO SNAP BUSHING #2182
37	40	CP-2939	HEX SERRATED FLANGE SCREW 0.375-16x1.000" ZINC PLATED
38	5	CP-671	FLAT WASHER .407IDx1.250ODx.125TH
39	2	CP-3049	HEX SERRATED FLANGE SCREW 0.375-16x2.000" ZINC PLATED
40	102	CP-2869	SERRATED FLANGE NUT 0.375-16 ZINC PLATED
41	4	CP-2941	HEX SERRATED FLANGE SCREW 0.313-18x0.750" ZINC PLATED
42	4	CP-3786	5/16 FLANGE HEX NUT
43	91	CP-2890	HEX SERRATED FLANGE SCREW 0.375-16x0.750" ZINC PLATED
44	32	CP-3067	HEX SERRATED FLANGE SCREW 0.250-20x0.500" ZINC PLATED
45	32	CP-3068	HEX FLANGE NUT 0.25-20
46	4	EL-395	HEYCO DOME PLUG #2733
47	1	CP-1003	1/4"SQ x 1.500 KEY
48	1	SNO-33-2-L-(L/R)	4"x90deg PS RAILS
49	1	SNO-33-2-L-(L/R)	4"x90deg PS RAILS
50	1	SNO-33-3-L-(L/R)	4"-90 X 3' P.S. SIDE RAIL
51	1	SNO-33-3-L-(L/R)	4"-90 X 3' P.S. SIDE RAIL
52	2	ACN-44-15	TRANSITION SIDE FOR SNO
53	1	SNO-44-1-L-1	4" BOTTOM SLIDE TRAY SIDE SUPPORT
54	1	SNO-44-1-L-2	4" BOTTOM SLIDE TRAY SIDE SUPPORT
55	1	SNO-44-1-L-1	4" BOTTOM SLIDE TRAY SIDE SUPPORT
56	1	SNO-44-1-L-2	4" BOTTOM SLIDE TRAY SIDE SUPPORT
57	1	2M-40-2-W	RETURN IDLER
58	4	2M-67-1	BEARING COVER

Part numbers listed in this document are for reference only. When buying replacement parts please provide your conveyor model & serial number to ensure the correct part.

SNO65 Merit Line Conveyor - Exploded View

NO.	QTY.	PART NO.	DESCRIPTION
59	1	3M-21-10-12-ID	ADCNO IDLER SHAFT
60	2	3M-40-5-625	ADCNO RETURN IDLER ROLLER
61	2	4M-15-1-2688-O	SNO TRANSITION IDLER FLANGE
62	4	4M-17-1	BLOCK FOR ADJ. IDLER ROLLER
63	2	4M-232-6	1" COLLAR ASS'Y FOR IDLER
64	2	4M-232-7	3/4" COLLAR ASS'Y. FOR IDLER
65	8	CP-2132	1/4 - 20 AVIBANK NUTSERT
66	6	CP-3671	ONE PIECE CLAMP-ON COLLAR, 3/4" BORE
67	18	CP-2856	HEX NUT INSERT 3/8-16 GRIP RANGE .027-.150 (AKPT6P616)
68	1	CP-1573	SERIAL PLATE,TRIMLINE,1-7/8 X 4-3/8
69	2	CP-1286	POP RIVET AVEX #1641-0514
70	8	CP-3340	FLAT WASHER .250
71	8	CP-106	HEX HEAD SCREW .250-20 x 1.500
72	1	SNO-75-1-W-CC-RH	SST CLEAT TRAP
73	1	SNO-275-3-W	SNO HOPPER 65 DEG
74	2	2E-236-X	LEG ASSY WELDMENT
75	2	2E-36-X	LEG EXTENSION
76	4	2M-14-16	LEG MOUNTING BRACKET
77	4	2S-241-2-W	CROSS BRACE
78	4	CP-508	HEX JAM NUT .500-13
79	4	CP-1239	SWIVEL CASTER, 4"X1 3/8"
80	2	2E-236-X	LEG WELD ASSY
81	2	2E-36-X	LEG EXTENSION
82	2	2M-14-11	BRACKET
83	2	4E-41-6	LEG TO FRAME BRACE
84	4	CP-2940	HEX SERRATED FLANGE SCREW 0.375-16x1.750" ZINC PLATED
85	2	4E-31-28	SPACER FOR K-3, K-4 CASTORS
86	1	BELT	CLEATED BELT FOR SNO65

Part numbers listed in this document are for reference only. When buying replacement parts please provide your conveyor model & serial number to ensure the correct part.