







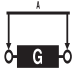

Key Eye Points

- Key Eye Points provide safer and more versatile handling of molds and other loads in your facility versus regular eye bolts.
- They enable loading from various lifting angles.
- Designed by forged alloy steel, quenched and tempered.
- 360° rotation.
- Bolt are Metric thread (ASME / ANSI B18.3.1M), specification is a grade 10.9 alloy socket head screw per DIN EN ISO 4762.
- Proof Load is 2.5 times Working Load Limit and certified according to EN1677-1.
- 20,000 cycle fatigue rated to 1.5 times Working Load Limit.
- 100% magnaflux crack detection.
- EMI ensures quick shipping and competitive prices.



Key Eye Point — Work load application examples:

											
Number of Points		1	2	1	2	2		2	3-4		
Load Direction		0°	0°	90°	90°	0-45°	45-60°	asim.	0-45°	0-45°	asim.
Quick#	Part#	Working Load Limit									
A300	EM8 8 291K 003	0.3t (1)	2	0.3	0.6	0.42	0.3	0.3	0.63	0.45	0.3
A301	EM10 8 291K 004	0.4t (1)	2	0.4	0.8	0.56	0.4	0.4	0.8	0.6	0.4
A302	EM12 8 291K 007	0.75t (2)	4	0.75	1.5	1	0.75	0.75	1.5	1.1	0.75
A303	EM16 8 291K 015	1.5t (4)	8	1.5	3	2.1	1.5	1.5	3.1	2.2	1.5
A304	EM20 8 291K 023	2.3t (6)	12	2.3	4.6	3.2	2.3	2.3	4.8	3.4	2.3
A305	EM24 8 291K 032	3.2t (8)	16	3.2	6.4	4.5	3.2	3.2	6.7	4.8	3.2
A306	EM30 8 291K 045	4.5t (12)	24	4.5	9	6.3	4.5	4.5	9.4	6.7	4.5
A307	EM36 8 291K 070	7t (16)	32	7	14	9.8	7	7	14.7	10.5	7
A308	EM42 8 291K 090	9t (24)	48	9	18	12.6	9	9	18.9	13.5	9
A309	EM48 8 291K 120	12t (32)	64	12	24	16.8	12	12	25	18	12

Key Eye Points

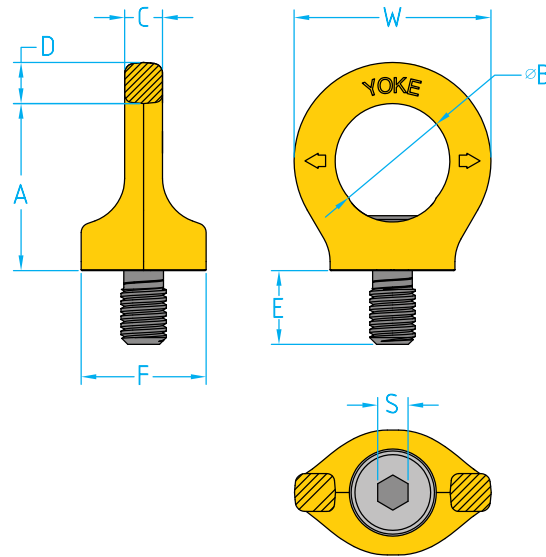

Key Eye Points — Metric Thread (Dimensions in mm)

Quick#	Part#	Thread	A	B	C	D	E	F	S	W	Working Load Limit	Price
A300	EM8 8 291K 003	M8	36	25	8	11	12	25	6	44	0.3t	\$17.96
A301	EM10 8 291K 004	M10	36	25	8	11	15	25	6	44	0.4t	\$18.33
A302	EM12 8 291K 007	M12	42	30	10	13	18	33	8	52	0.75t	\$20.56
A303	EM16 8 291K 015	M16	51	35	14	13	24	35	10	61	1.5t	\$23.52
A304	EM20 8 291K 023	M20	57	40	16	17	30	44	12	70	2.3t	\$34.63
A305	EM24 8 291K 032	M24	70	48	19	21	36	42	14	84	3.2t	\$42.78
A306	EM30 8 291K 045	M30	86	60	24	26	45	62	17	108	4.5t	\$61.85
A307	EM36 8 291K 070	M36	103	72	29	32	54	78	22	130	7t	\$96.11
A308	EM42 8 291K 090	M42	120	82	34	38	63	88	24	150	9t	\$172.04
A309	EM48 8 291K 120	M48	137	94	38	43	72	104	27	168	12t	\$229.63

Key Eye Points — UNC Thread (Dimensions in inches)

Quick#	Part#	Thread	A	B	C	D	E	F	S	W	Working Load Limit	Price
A325	E5/16 8 292K 003*	5/16 - 18UNC	1.42	0.98	0.33	0.43	0.47	0.98	0.24	1.73	660 lbs	\$17.96
A326	E3/8 8 292K 004*	3/8 - 16UNC	1.42	0.98	0.33	0.43	0.59	0.98	0.24	1.73	880 lbs	\$18.33
A327	E1/2 8 292K 007*	1/2 - 13UNC	1.65	1.18	0.39	0.51	0.71	1.30	0.31	2.05	1650 lbs	\$20.56
A328	E5/8 8 292K 015*	5/8 - 11UNC	2.01	1.38	0.55	0.51	0.94	1.38	0.39	2.40	3300 lbs	\$23.52
A329	E3/4 8 292K 023*	3/4 - 10UNC	2.24	1.57	0.63	0.67	1.18	1.73	0.47	2.76	5060 lbs	\$34.63
A330	E7/8 8 292K 032*	7/8 - 9UNC	2.76	1.89	0.75	0.83	1.42	2.05	0.55	3.31	5060 lbs	\$42.78
A331	E1 8 292K 045*	1 - 8UNC	3.39	2.36	.94	1.02	1.77	2.44	0.67	4.25	7040 lbs	\$61.85
A332	E1 1/4 8 292K 070*	1½ - -UNC	4.06	2.83	1.14	1.26	2.13	3.07	0.87	5.12	15400 lbs	\$96.11
A333	E1 3/4 8 292K 090*	1¾ - 5UNC	4.72	3.23	1.34	1.50	2.48	3.46	0.94	5.91	19800 lbs	\$172.04
A334	E2 8 292K 120*	2 - 4.5UNC	5.39	3.70	1.50	1.69	2.83	4.09	1.06	6.61	26400 lbs	\$229.63

Note: * = non-stock item

Mold Supplies