

SECTION VIII. PARTS LISTS AND 3-D DRAWINGS

KKI CONVEYOR - ASSEMBLED VIEW

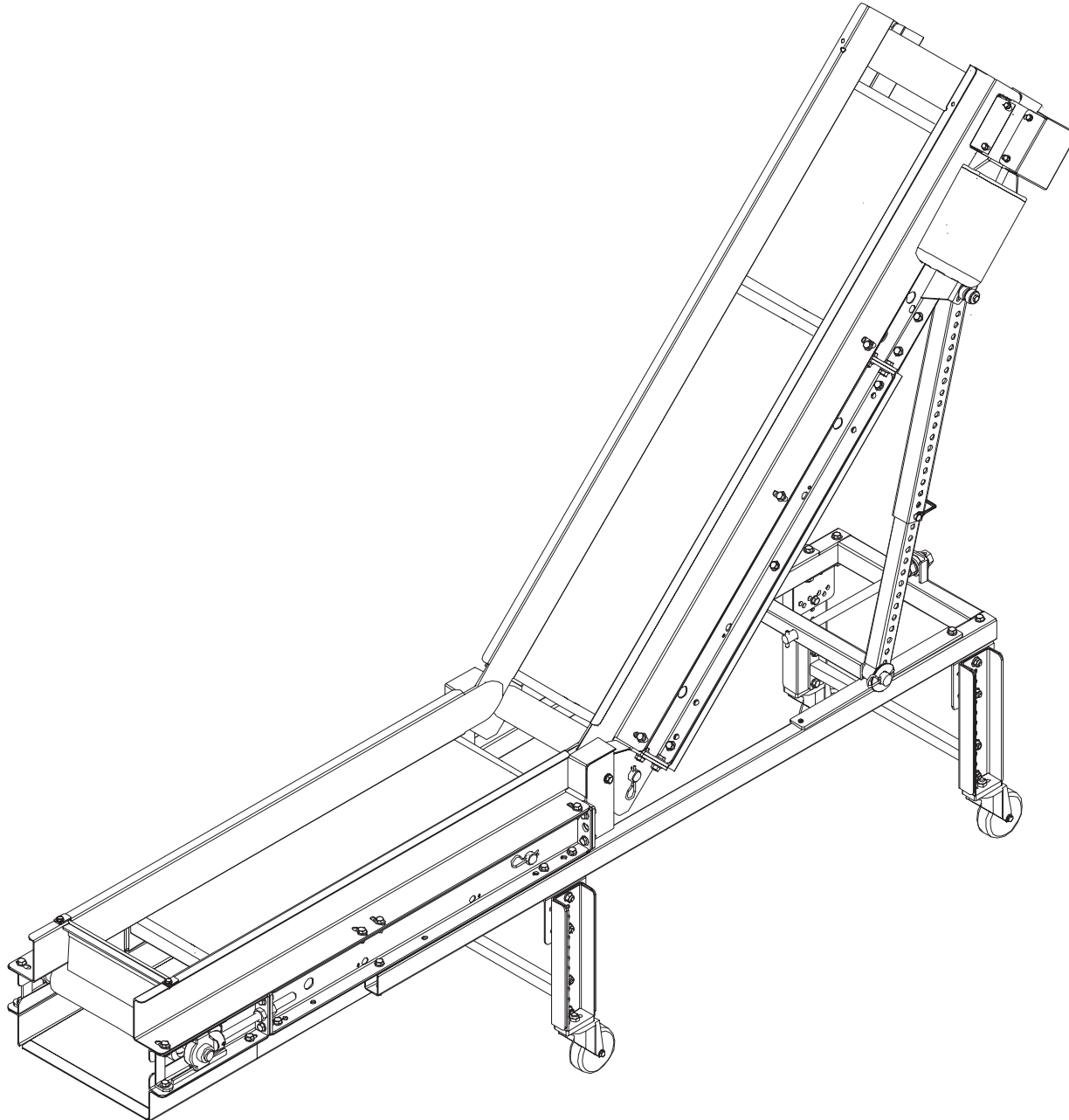

SECTION VIII. PARTS LISTS AND 3-D DRAWINGS

KKI CONVEYOR - CATALOG VIEW

2' AND 3' "B" DIMENSION = 20° TO 45° ANGLE ADJUSTMENT
 4' AND 6' "B" DIMENSION = 12° TO 45° ANGLE ADJUSTMENT
 THE DRIVE IS LOCATED ON THE INFEED OF 24" WIDE MODELS

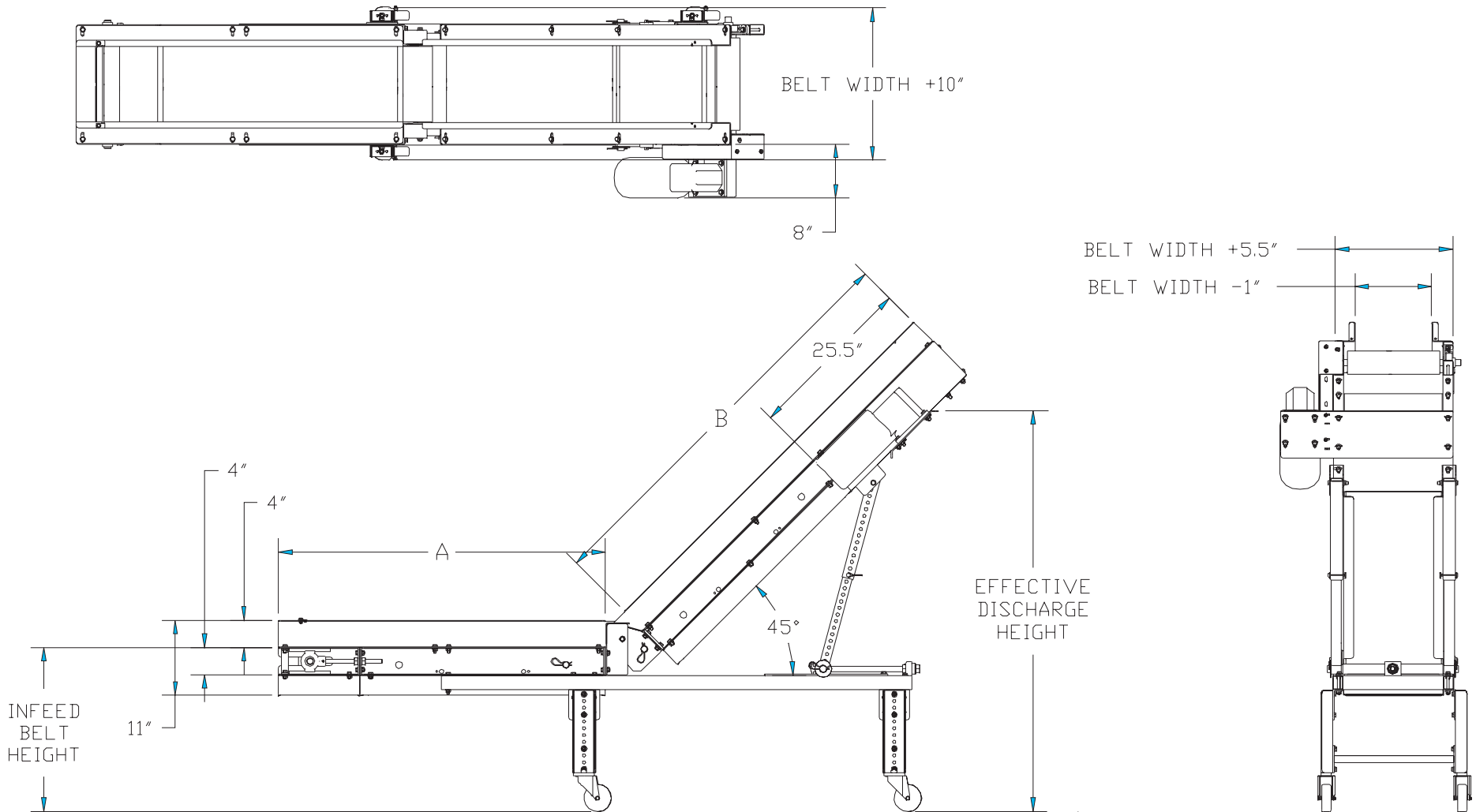

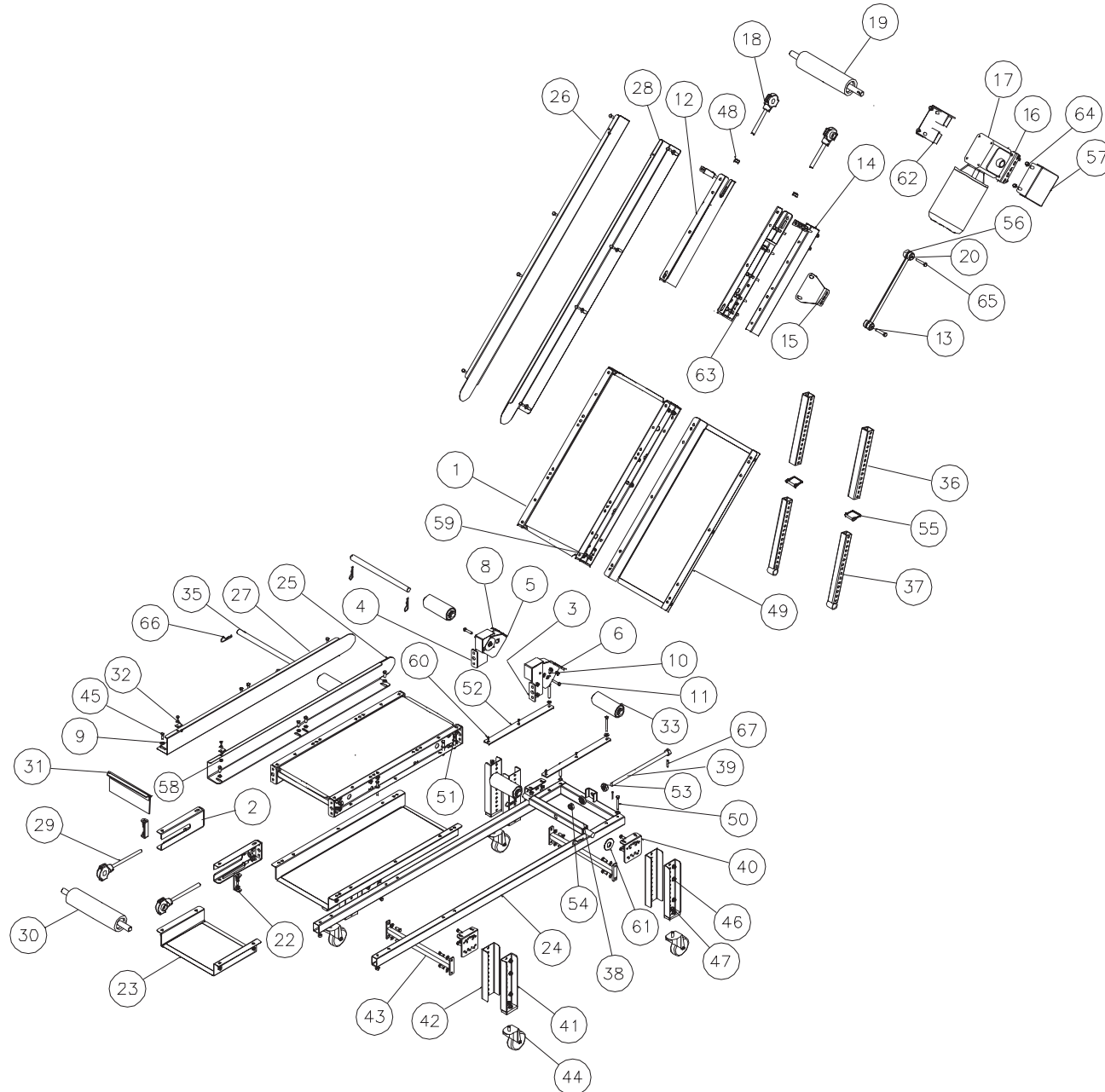
SECTION VIII. PARTS LISTS AND 3-D DRAWINGS**KKI CONVEYOR - EXPLODED VIEW**

KKI CONVEYOR PARTS LIST

| ITEM | QTY | PART DESCRIPTION | EMI P/N |
|------|-----|-------------------------------------|---------------|
| 1 | 2 | FRAME ASSY | 4E-206-1-W |
| 2 | 2 | TAIL ASSY | 4E-258-2 |
| 3 | 1 | RH INFEED PIVOT BRACKET | 7C-214-6 |
| 4 | 1 | LH INFEED PIVOT BRACKET | 7C-214-9 |
| 5 | 1 | RH DISCHARGE PIVOT BRACKET | 7C-214-5 |
| 6 | 1 | LH DISCHARGE PIVOT BRACKET | 7C-214-8 |
| 7 | 6 | 3/8 X 1-1/4 OD WASHER | CP-671 |
| 8 | 2 | TRANSITION ROLLER (BUSHING- CP-857) | 4E-40-13 |
| 9 | 91 | 3/8 FLAT WASHER | CP-662 |
| 10 | 2 | 3/8 LOCK WASHER | CP-700 |
| 11 | 2 | 3/8-24x1- 3/4 HEX BOLT | CP-127 |
| 12 | 1 | DRIVE HEAD ASSY | 4E-204-1-W |
| 13 | 1 | MOTOR & REDUCER SUPPORT | 4E-29-23-W |
| 14 | 2 | MOTOR MOUNT SPACER TUBE | *See Next Pg. |
| 15 | 1 | MOTOR & REDUCER | See BOM |
| 16 | 1 | CHAIN GUARD | *See Next Pg. |
| 17 | 1 | CHAIN GUARD COVER | *See Next Pg. |
| 18 | 2 | DRIVE PULLEY TAKE-UP BEARING | 2E-232-3 |
| 19 | 1 | DRIVE PULLEY | 2E-210-3-W |
| 20 | 1 | SPROCKET | CP-1295 |
| 21 | 1 | SPROCKET | CP-1364 |
| 22 | 4 | END BRACKET | 4E-14-1 |
| 23 | 1 | 1' TAIL BOTTOM SLIDE TRAY | *See Next Pg. |
| 24 | 1 | ANGLE ADJUSTMENT | See BOM |
| 25 | 1 | LH INFEED RAIL | 7C-33-4L |
| 26 | 1 | RH DISCHARGE RAIL | 7C-33-4L |
| 27 | 1 | RH INFEED RAIL | 7C-33-5L |
| 28 | 1 | LH DISCHARGE RAIL | 7C-33-5L |
| 29 | 2 | TAIL PULLEY TAKE-UP BEARING | 2E-232-2 |
| 30 | 1 | TAIL PULLEY | 2E-224-2-W |
| 31 | 1 | FLAPPER ASSY | 2E-249-5-W |
| 32 | 2 | FLAPPER CLIP | 2E-01-10 |
| 33 | 4 | IDLER ROLLER ASSY | 2E-240-36-W |
| 34 | 2 | TELESPAR BRACKET | 7C-14-10 |

| ITEM | QTY | PART DESCRIPTION | EMI P/N |
|------|-----|---|---------------|
| 35 | 2 | IDLER SHAFT | 2E-21-35-W |
| 36 | 2 | TELESPAR LEG | *See CHART |
| 37 | 2 | TELESPAR LEG ASSY | *See CHART |
| 38 | 1 | ANGLE ADJUSTMENT | 7C-214-1-W |
| 39 | 1 | ADJUSTMENT SCREW | 7C-232-1 |
| 40 | 4 | LEG MOUNTING BRACKET | 4E-14-3 |
| 41 | 4 | LEG WELD ASSY | *See CHART |
| 42 | 4 | LEG EXTENSION | *See CHART |
| 43 | 2 | LEG BRACE ASSY | 4E-241-1-W |
| 44 | 4 | CASTOR | CP-1239 |
| 45 | 51 | 3/8-24x1 HEX BOLT | CP-141 |
| 46 | 89 | 3/8-24 HEX NUT | CP-521 |
| 47 | 4 | 1/2-13 HEX JAM NUT | CP-508 |
| 48 | 8 | 5/8-11 HEX NUT | CP-505 |
| 49 | 2 | BOTTOM SLIDE TRAY | *See Next Pg. |
| 50 | 4 | 3/8-24x2-3/4 HEX BOLT | CP-167 |
| 51 | 8 | 3/8-24x3 HEX BOLT | CP-154 |
| 52 | 2 | UHMW GUIDE | 7C-35-1 |
| 53 | 2 | THRUST BEARING | CP-839 |
| 54 | 1 | LOCK NUT | CP-1521 |
| 55 | 2 | CLIP PIN | CP-2889 |
| 56 | 7 | 1/4 WASHER | CP-654 |
| 57 | 4 | 1/4-28X3/4 HEX BOLT | CP-125 |
| 58 | 4 | 1/4-28 HEX NUT | CP-517 |
| 59 | 10 | 3/8-24x3/4 HEX BOLT | CP-126 |
| 60 | 4 | 10-32x1/2 SLOTTED FLAT COUNTERSUNK HEAD CAP SCREW | CP-267 |
| 61 | 2 | 1" FLAT WASHER | CP-1533 |
| 62 | 1 | BELT SUPPORT | 4E-29-91-W |
| 63 | 12 | 3/8-24x4 HEX BOLT | CP-153 |
| 64 | 4 | 3/8-24x1-1/2 HEX BOLT | CP-137 |
| 65 | 3 | 1/4-20x3/4 SLOTTED ROUND HEAD CAP SCREW | CP-2305 |
| 66 | 6 | SPRING PIN | CP-1285 |
| 67 | 2 | 1/4 X 1-1/2 ROLL PIN | CP-1360 |
| 68 | 1 | CHAIN (NOT SHOWN) | 2E-40-4 |

Part numbers listed in this document are for reference only. When buying replacement parts please provide your conveyor model & serial number to ensure the correct part.

KKI CONVEYOR PARTS LIST - ADDITIONAL ITEMS

Item #14:

| | |
|---------|----------|
| 2" Drop | 4E-31-1 |
| 3" Drop | 4E-31-32 |

Item #23:

| | |
|---------|--------------|
| 2" Drop | 4E-245-21-W |
| 3" Drop | 4E-245-150-W |
| 4" Drop | 4E-245-22-W |

Item #16:

| | |
|-------|-----------|
| 2" LH | 4E-08-1 |
| 2" RH | 4E-08-1 |
| 3" LH | 4E-08-108 |
| 3" RH | 4E-08-108 |

Item #49:

| | |
|---------|--------------|
| 2" Drop | 4E-245-L-W |
| 3" Drop | 4E-245-15L-W |
| 4" Drop | 4E-245-1L-W |

Item #17:

| | |
|-------|----------|
| 2" LH | 4E-67-1 |
| 2" RH | 4E-67-2 |
| 3" LH | 4E-67-84 |
| 3" RH | 4E-67-85 |