

Gimatic® C-Slot Sensors

C-Slot Sensors

Part#	Quick#	Price	Type	Signal	Connection	Power Supply	Max. Switching Frequency	Voltage Drop	Operating Temperature	IEC Rating	Cable
SS4N225G	1882	\$26.14	3-wire Magneto-resistive	PNP	2.5m lead	6-30V dc	200 KHz	1V dc	-10 to +70°C	IP 67	PUR Sheath
SS4M225G	1883	\$26.14	3-wire Magneto-resistive	NPN	2.5m lead	6-30V dc	200 KHz	1V dc	-10 to +70°C	IP 67	PUR Sheath
SS3N203G	6282	\$29.96	3-wire Magneto-resistive	PNP	.3m lead & M8	6-30V dc	200 KHz	1V dc	-10 to +70°C	IP 67	PUR Sheath
SS3M203G	1884	\$29.96	3-wire Magneto-resistive	NPN	.3m lead & M8	6-30V dc	200 KHz	1V dc	-10 to +70°C	IP 67	PUR Sheath
SS1C225-G	6600	\$17.60	2-wire REED	PNP/NPN	2.5m lead	3-30V AC/DC	500 Hz	3V	-10 to +70°C	IP 67	PUR Sheath
SS2C203-G	6601	\$18.20	2-wire REED	PNP/NPN	.3m lead & M8	3-30V AC/DC	500 Hz	3V	-10 to +70°C	IP 67	PUR Sheath

Note: Reed Sensors are not recommended for grippers (Cylinders only).

SN4N225G	6278	\$26.14	3-wire Magneto-resistive	PNP	2.5m Lead	6-30V dc	200 KHz	1V dc	-10 to +70°C	IP 67	PUR Sheath
SN4M225G	6357	\$26.14	3-wire Magneto-resistive	NPN	2.5m Lead	6-30V dc	200 KHz	1V dc	-10 to +70°C	IP 67	PUR Sheath
SN3N203G	6277	\$29.96	3-wire Magneto-resistive	PNP	.3m lead & M8	6-30V dc	200 KHz	1V dc	-10 to +70°C	IP 67	PUR Sheath
SN3M203G	6356	\$29.96	3-wire Magneto-resistive	NPN	.3m lead & M8	6-30V dc	200 KHz	1V dc	-10 to +70°C	IP 67	PUR Sheath
K-SENS	7440	\$4.63	This adapter allows 'C' channel sensors to work in 'T' channel slots.								

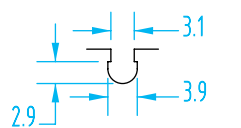

C-Slot dimensional drawing

